

1

2

3

4

5

6

7

A

A

B

B

C

C

D

D

E

E

F

F

G

G

H

H

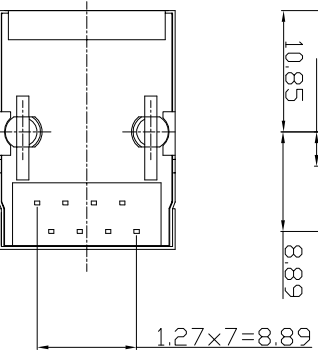
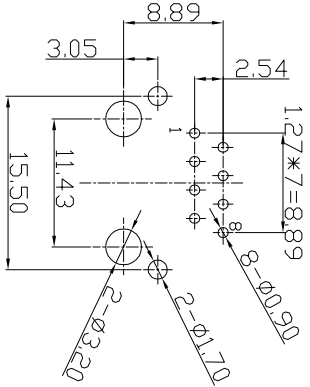
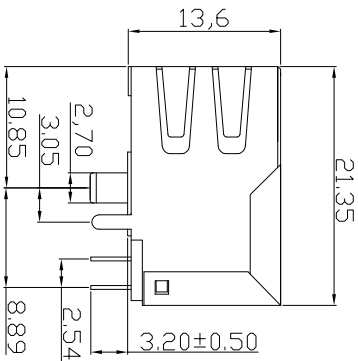
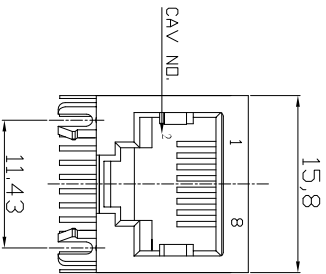

Frequenz	Return Loss	Return Loss	Return Loss
kHz	dB, Min.	dB, Max.	dB, Max.
10	65	30	0.1
40	65	30	0.1
80	64.9	30	0.1
100	63	30	0.1
160	58.9	30	0.2
200	57	30	0.2
250	55	30	0.2
3125	53.1	30	0.2
625	47.1	24.1	0.3
1000	43	20	0.4

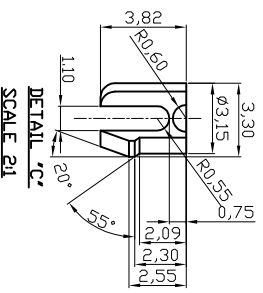

- Notes:
- Electrical:
    - 1. Voltage Rating : 125 Vac.
    - 2. Current Rating : 1.5 A
    - 3. Contact Resistance : 60 Milliohms Max.
    - 4. Insulation Resistance : 1000 Megohms Min. @ 500 Vac.
    - 5. Dielectric Strength : 1000 Vac 60Hz, 1Min.
  - Mechanical:
    - 1. Shield : ±0.25mm Brass C2680 H,
    - 2. Housing : Plated 30µ"-50µ" Nickel
    - 3. PCB : High Temp. UL 94V-0.
    - 4. Contact : FR-4, 0.5mm Thickness.
    - 5. Operating Life : 750 Cycles Min.
    - 6. Environmental:
      - 1. Storage : -40°C To +85°C.
      - 2. Operation : -40°C To +85°C.
- Mates With Modular Plug Conforming To FCC PART 68, Subpart F.

**RoHS compliant**  
Unit: mm

Scale	Free
TOLERANCE	
.X	±0.20
.XX	±0.15
.XXX	±0.10
DIM	TOL
Angle	±5°

Id.	Modification	Date	Name
①	Drawn	20.11.2007	N.Schulz
②	Add detail "c"	06.07.2009	Dean
③	Update the contact plating	25.08.2015	Amy

Date	Name	Customer-No.
20.11.2007	N.Schulz	
25.08.2015	Amy	

ASSMANN WSW-NO.  
AMJ-188-0010100-CAT5



ASS 2412 CO rev03

Replace Sheet