

1

2

3

4

5

6

7

A

B

C

D

E

F

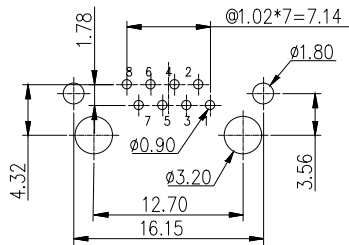
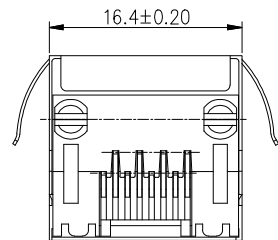
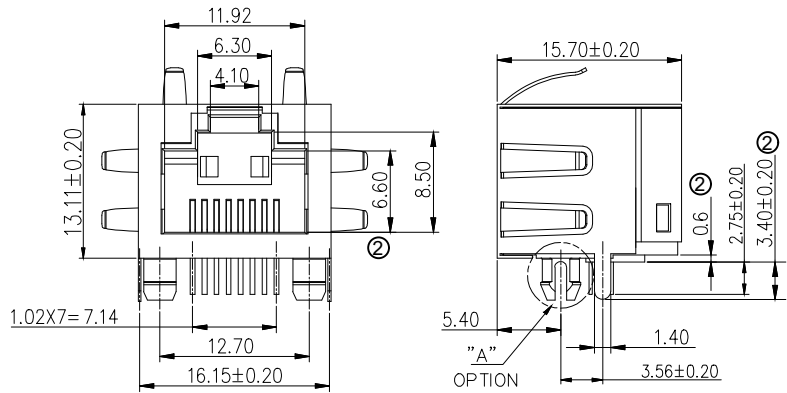

PC Board Layout Component Side Shown

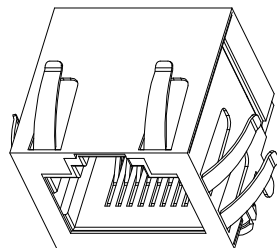

Notes:

Electrical:

- 1. Voltage Rating: 125VAC
- 2. Current Rating: 1.5AMP
- 3. Contact Resistance: 30mΩ max.
- 4. Insulation Resistance: 1000MΩ min. @ 500VDC
- 5. Dielectric Strength: 1000VAC 60Hz, 1 min.
- 6. Operating: 1500 cycles min.

Mechanical:

- 1. Housing Material: High Temp. UL94V-0 Black
- 2. Back Plate Material: Glass Filled Polyester UL94V-0 Black
- 3. Contact Material: Phosphor Bronze t=0.30mm
- 4. Contact Plating: 6u" Gold on contact area  
100~200u" Tin on solder area  
All over 30~50u" Nickel
- 5. PCB Retention Pre-solder: 1 LB min.
- 6. PCB Retention Post-solder: 10 LBS min.

Environmental:

- 1. Storage: -40°C to +85°C
- 2. Operation: -40°C to +85°C
- 3. Wave Soldering Temperature: 255~265°C (5~10 seconds)

Mates with Modular Plug conforming to TIA-1096-A

Package: Tray

RoHS compliant  
Unit: mm

G	Scale	Free					Date	Name	Description: Modular Jack RJ45 Without LED		
	TOLERANCE					Drawn	08.09.2015	Amy			
	.X	±0.20				Approved	11.09.2023	Segal	ASSMANN WSW-No. A-MJH-8-EA-GRP-S6		
	.XX	±0.15									
	.XXX	±0.10	②	Update the dimensions	11.09.2023	Segal					
H	DIM	TOL	①	Add the new part A-MJH-8-EA-GRP-S6	24.09.2020	Winnie	 A company of 		Drawing-No. ASS 6975 CO rev02		
	Angle	±5°	①	Drawn	08.09.2015	Amy			Customer-No.		Sheet 1/2
			Id.	Modification	Date	Name					

1

2

3

4

5

6

7

1 2 3 4 5 6 7

A B C D E F

PC Board Layout Component Side Shown

Notes:

Electrical:

1. Voltage Rating: 125VAC
2. Current Rating: 1.5AMP
3. Contact Resistance: 30mΩ max.
4. Insulation Resistance: 1000MΩ min. @ 500VDC
5. Dielectric Strength: 1000VAC 60Hz, 1 min.
6. LED Rating: Forward Voltage: 2.2V typical  
Reverse Voltage: 5V max.
7. Operating: 1500 cycles min.

Mechanical:

1. Housing Material: High Temp. UL94V-0 Black
2. Back Plate Material: Glass Filled Polyester UL94V-0 Black
3. Contact Material: Phosphor Bronze t=0.30mm
4. LED Size: 7x3.05x1.85, P=2.54mm
5. Contact Plating: 6u" Gold on contact area  
100~200u" Tin on solder area  
All over 30~50u" Nickel
6. PCB Retention Pre-solder: 1 LB min.
7. PCB Retention Post-solder: 10 LBS min.

Environmental:

1. Storage: -40°C to +85°C
2. Operation: -40°C to +85°C
3. Wave Soldering Temperature: 255~265°C (5~10 seconds)

Mates with Modular Plug conforming to TIA-1096-A

Package: Tray

**RoHS compliant**  
Unit: mm

Scale	Free						Date	Name	Description: Modular Jack RJ45 With LED	
TOLERANCE						Drawn	08.09.2015	Amy	ASSMANN WSW-No. A-MJL-8-EA-GRP-SYG3	
.X	±0.20					Approved	11.09.2023	Segal	Drawing-No. ASS 6975 CO rev02	
.XX	±0.15								Customer-No. Sheet 2/2	
.XXX	±0.10	②	Update the dimensions	11.09.2023	Segal					
DIM	TOL	①	Add the new part A-MJH-8-EA-GRP-S6	24.09.2020	Winnie					
Angle	±5°	①	Drawn	08.09.2015	Amy					
		Id.	Modification	Date	Name	A company of				

1 2 3 4 5 6 7