

1	2	3	4	5	6	7
---	---	---	---	---	---	---

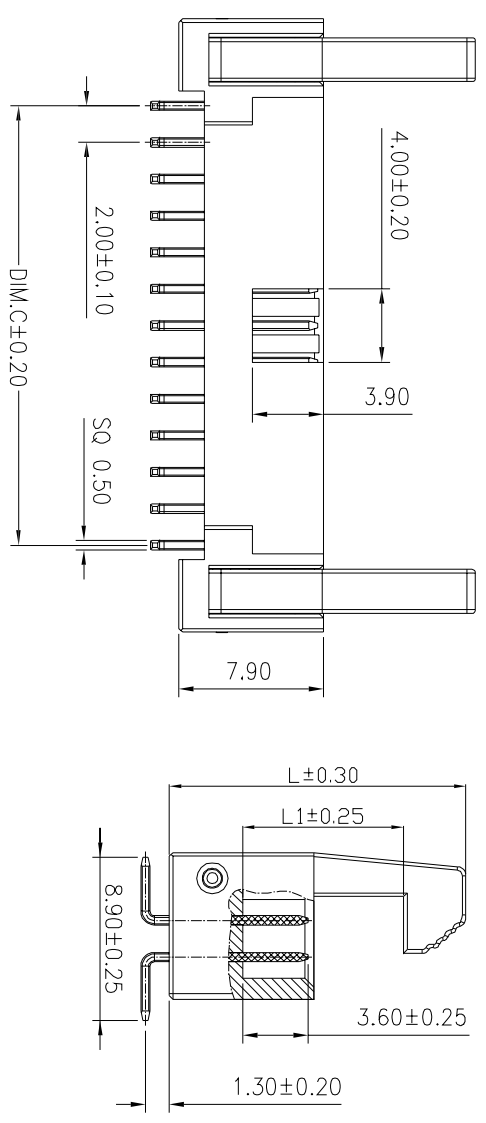
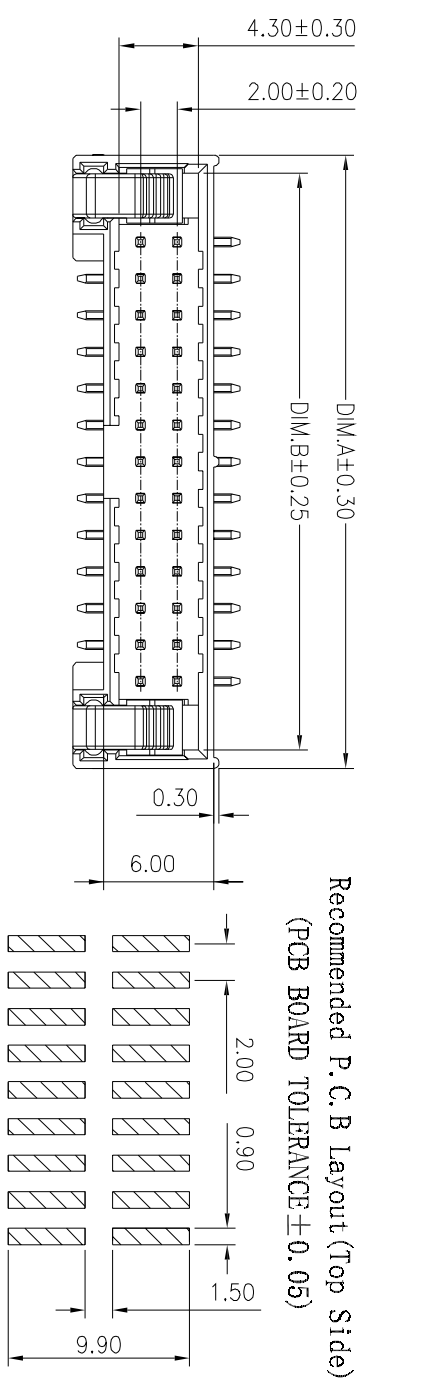

- NOTES:**
- MATERIAL**
1. Insulator Material: PA9T+30%G.F. (UL94V-0), Black
 2. Latch Material: PA9T+30%G.F. (UL94V-0), Black
 3. Contact Material : Brass
 4. Contact Plating : Gold Flash / Over Ni
 5. Fix Axle: Brass
- ELECTRICAL**
1. Current Rating : 1.0AMP
 2. Withstand Voltage : 500V AC/minute
 3. Contact Resistance : 20mΩ max
 4. Insulation Resistance : 100MΩ min
- ENVIRONMENTAL**
1. Operation Temperature: -40°C to +105°C
 2. Soldering Temperature: 255°C±5°C/5s±1s
 3. Packing : Tube
 4. No. of Contact : 10-68
- Order Code:
 AWHW-200-xx-ST10 : Short Latch
 AWHW-200-xx-ST12 : Long Latch

No. OF POSITION	DIM.A	DIM.B	DIM.C
10	17.50	15.50	8.00
12	19.50	17.50	10.00
14	21.50	19.50	12.00
16	23.50	21.50	14.00
20	27.50	25.50	18.00
22	29.50	27.50	20.00
24	31.50	29.50	22.00
26	33.50	31.50	24.00
30	37.50	35.50	28.00
34	41.50	39.50	32.00
40	47.50	45.50	38.00
44	51.50	49.50	42.00
48	55.50	53.50	46.00
50	57.50	55.50	48.00
68	75.50	73.50	66.00

RoHS compliant
Unit: mm

Scale	Free	Date	Name
TOLERANCE	±0.40	08.08.2017	Winnie
X.XX	±0.25	25.01.2018	Winnie
X.XXX	±0.15		
Angle	±3°		

Id.	Modification	Date	Name
①	Update the P/N & the latch on the drawing	25.01.2018	Winnie
②	Drawn	08.08.2017	Winnie

Customer-No.	ASSMANN WSW-No.	Drawing-No.
	AWHW-200-xx-ST10 AWHW-200-xx-ST12	ASS 7742 CO
		rev01
		Sheet

1	2	3	4	5	6	7
---	---	---	---	---	---	---