

① **USB2.0 COMPLIANT**

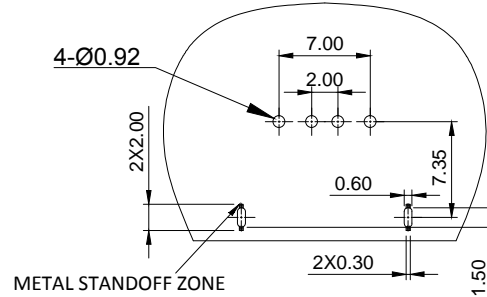

RECOMMENDED PCB LAYOUT (COMPONENT SIDE)
TOLERANCE+0.05mm PCB THICKNESS 1.20mm

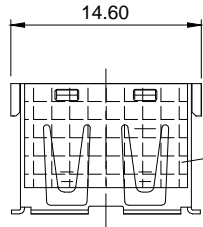
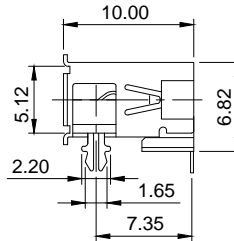
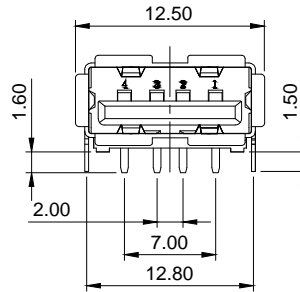

Notes:

Material:
Contact:

Brass T=0.20mm
Gold Flash on mating area
Sn 100u" min. plated on soldering
50u" Nickel under plating overall
Insulator Material: LCP+30% G.F. UL94V-0 Black
Shell: Brass T=0.30mm Nickel over all plating

Insulator Material:
Shell:

Electrical:

Current rating: 1.5Amps/contact max.
Rated Voltage: 30V
Contact Resistance: ≤30mΩ/contact
Insulation Resistance: ≥100MΩ at V=100V
Withstanding Voltage: 500VAC/minute

Mechanical:

Mating: 35N max.
Withdraw force: 10N min.
Durability: 1500 cycles min.

Environmental:

Temperature Range: -55C°~+85C°
Packing: Tape & Reel+Mylar

RoHS compliant
Unit: mm

Scale	Free					Date	Name	Customer-No.	
TOLERANCE						Drawn	14.06.2018	Xavier	
X.						Approved	14.06.2018	Winnie	
X.X	±0.30							ASSMANN WSW-No. A-USB2-AFN-EA-GRR50	
X.XX	±0.20							Drawing-No.	
X.XXX	±0.10	①	Update	15.08.2019	Xavier	ASSMANN WSW components		ASS 8001 CO	rev01
DIM	TOL	②	Drawn	14.06.2018	Winnie			Replace	Sheet 1/1
X. °	±5°								
Angle	TOL	Id.	Modification	Date	Name				