

1

2

3

4

5

6

7

A

A

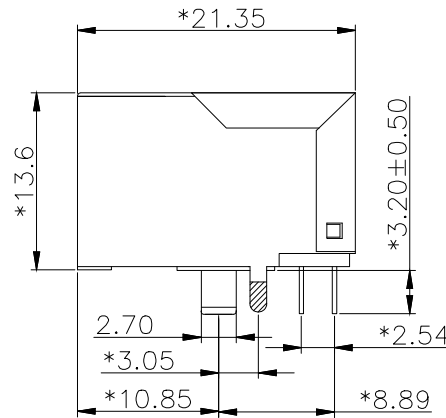
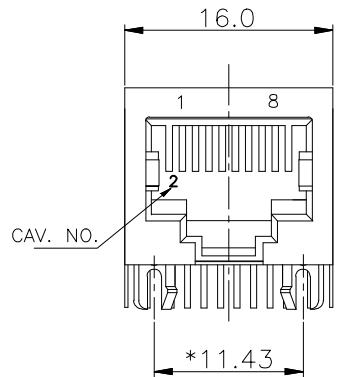

Notes :

Electrical :

- 1. Voltage Rating : 125 Vac.
- 2. Current Rating : 1.5 A
- 3. Contact Resistance : 60 MilliOhms Max.
- 4. Insulation Resistance : 1000 Megohms Min. @ 500 Vdc
- 5. Dielectric Strength : 1000 Vac 60Hz, 1Min.

Mechanical :

- 1. Shield : t=0.25mm Brass C2680 H, Plated 30u"~50u" Nickel.
- 2. Housing : High Temp. UL 94V-0.
- 3. PCB : FR-4, 0.5mm Thickness.
- 4. Contact : Phosphor Bronze t=0.35mm. Selective Gold Plating Over 50u"Nickel.
- 5. Operating Life : 750 Cycles Min.

Environmental :

- 1. Storage : -40°C To +85°C.
- 2. Operation : -40°C To +85°C.

Mates With Modular Plug Conforming To TIA-1096-A.

B

B

C

C

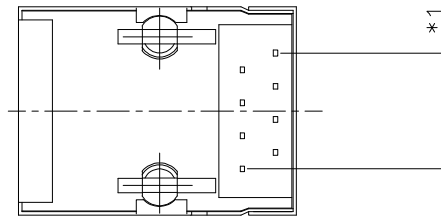
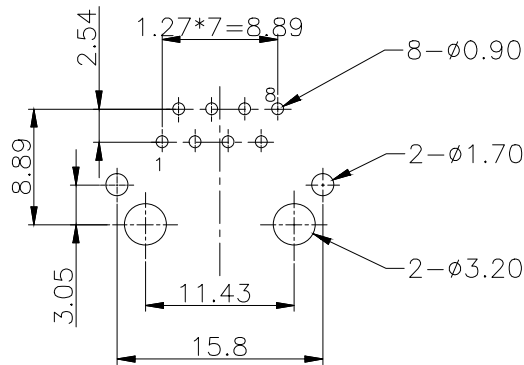

Order Code:

A-MJH-8-EA-xTP-S6

- K = Gold flash selective tin
- P = 15u" Au/Sn
- H = 30u" Au/Sn
- L = 50u" Au/Sn

PC Board Layout Component Side Shown

D

D

E

E

F

F

G

G

RoHS compliant

Unit:mm

Scale Free

TOLERANCE

X.X ±0.20

X.XX ±0.15

X.XXX ±0.10

DIM TOL

X.° ±5°

Angle TOL

Drawn	07.06.2021	Luca
Approved	07.06.2021	Luca
Id.	Modification	Date Name

Date Name

Drawn 07.06.2021 Luca

Approved 07.06.2021 Luca

ASSMANN
WSW components

Description: Modular Connector	
RJ45 / Female / THT / Side Entry / Cat5e / Shielded	
ASSMANN WSW-No.	
A-MJH-8-EA-xTP-S6	
Drawing-No.	rev00
ASS 8954 CO	
Customer-No.	SHEET 1 / 2

H

H

1

2

3

4

5

6

7

1

2

3

4

5

6

7

A

A

Technical drawing of a modular connector showing front, side, and top views with dimensions and callouts.

Front View Dimensions: 16.0 (width), 11.43 (width of contact area), 3.10±0.50 (height), 1.27*7=8.89 (pitch), 2.54 (height of top contact), 8-∅0.90 (8 holes), 2-∅1.70 (2 holes), 2-∅3.20 (2 holes), 11.43 (width of mounting holes), 15.8 (width of mounting holes), 3.05 (height of mounting holes).

Side View Dimensions: *21.35 (width), *13.6 (height), *3.20±0.50 (height of contact area), 2.70 (width of contact area), *3.05 (width of contact area), *2.54 (width of contact area), *10.85 (width of contact area), *8.89 (width of contact area), 6.80±0.50 (width of contact area), 2.30±0.50 (height of contact area), *1.27x7=8.89 (pitch).

Top View Dimensions: 8-∅0.90 (8 holes), 2-∅1.70 (2 holes), 2-∅3.20 (2 holes), 11.43 (width of mounting holes), 15.8 (width of mounting holes), 3.05 (height of mounting holes).

Callouts: 1, 2, 8, CAV. NO., 8-∅0.90, 2-∅1.70, 2-∅3.20.

Notes :

Electrical :

1. Voltage Rating : 125 Vac.
2. Current Rating : 1.5 A
3. Contact Resistance : 60 MilliOhms Max.
4. Insulation Resistance : 1000 Megohms Min. @ 500 Vdc
5. Dielectric Strength : 1000 Vac 60Hz, 1Min.

Mechanical :

1. Shield : t=0.25mm Brass C2680 H, Plated 30u"~50u" Nickel.
2. Housing : High Temp. UL 94V-0.
3. PCB : FR-4, 0.5mm Thickness.
4. Contact : Phosphor Bronze t=0.35mm. Selective Gold Plating Over 50u"Nickel.
5. Operating Life : 750 Cycles Min.

Environmental :

1. Storage : -40°C To +85°C.
2. Operation : -40°C To +85°C.

Mates With Modular Plug Conforming To TIA-1096-A.

Order Code:

A-MJH-8-EA-xTP-S7

K = Gold flash selective tin

P = 15u" Au/Sn

H = 30u" Au/Sn

L = 50u" Au/Sn

PC Board Layout Component Side Shown

G

G

RoHS compliant

Unit:mm

Scale Free

TOLERANCE

X.X ±0.20

X.XX ±0.15

X.XXX ±0.10

DIM TOL

X.° ±5°

Angle TOL

Free

ⓐ

Id.