

NOTE:

1.MATERIAL:
 1.1 Insulator: PPS
 1.2 Terminal: Phosphor Bronze
 1.3 Gasket: Phosphor Bronze
 1.4 Nut: Brass
 1.5 Fixed metal part: Riveted copper
 1.6 Case: Brass
 1.7 O-ring: Silicon rubber

2.MECHANICAL
 2.1 Durability: 4500 cycles min

3.Protection garde: IP66
 4.Operating temperature: -50°C to +200°C

Order Code:A-CPPK-XX-FGMS-GHB01

Electrical character

Series	PIN Number (Solder)	Terminalø	Test voltage(KV rms)		Rated current(A)
			Pin-Pin	Pin-Shell	
02		0.9	1.30	1.05	10.0
03		0.9	1.20	0.90	8.0
04		0.7	0.85	0.70	7.0
05		0.7	1.00	0.70	6.5
06		0.5	0.85	0.65	2.5
07		0.5	0.80	0.70	2.5
09		0.5	0.60	0.50	2.0

RoHS compliant
unit:mm

Scale	Free					Date	Name	Description: Circular Connector Push Pull Self Lock / Female
TOLERANCE						Drawn	22.09.2021	
.X	±0.50					Approved	22.09.2021	Peter
.XX	±0.20							
DIM	TOL							
X.°	±2.0°	①	Drawn	22.09.2021	Peter			Drawing-No.
.X°	±1.0°							ASS 9029 CO
Angle	TOL	Id.	modification	Date	Name	Customer-No.		SHEET 1 / 2

ASSMANN WSW-NO.
A-CPPK-XX-FGMS-GHB01

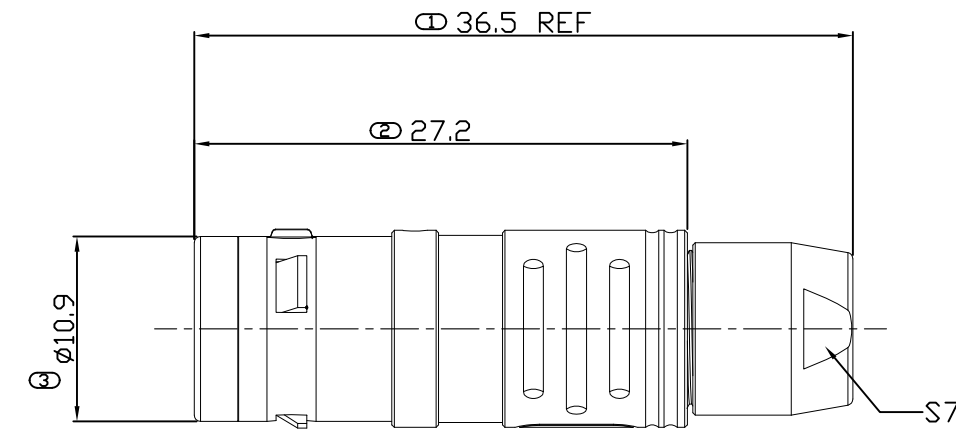

- NOTE:**
- MATERIAL:**
 - 1.1 Insulator: PPS
 - 1.2 Terminal: Brass
 - 1.3 Clamp: Riveted copper
 - 1.4 Insulation clip: Brass
 - 1.5 Locking sleeve: Riveted copper
 - 1.6 Shell+tail cover: Brass
 - 1.7 O-ring: Silicon rubber
 - MECHANICAL**
 - 2.1 Durability: 4500 cycles min
 - Protection garde:** IP66
 - Operating temperature:** -50°C to +200°C

Order Code: A-CPPK-XX-MGMS-GHB01

Electrical character

Series	PIN Number (Solder)	Terminalø	Test voltage(KV rms)		Rated current(A)
			Pin-Pin	Pin-Shell	
02	1-2	0.9	1.30	1.05	10.0
03	1-3	0.9	1.20	0.90	8.0
04	1-4	0.7	0.85	0.70	7.0
05	1-5	0.7	1.00	0.70	6.5
06	1-6	0.5	0.85	0.65	2.5
07	1-7	0.5	0.80	0.70	2.5
09	1-9	0.5	0.60	0.50	2.0

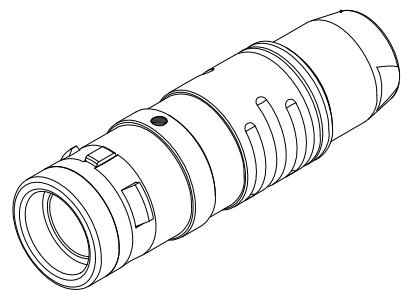

RoHS compliant
unit:mm

Scale	Free
TOLERANCE	
.X	±0.50
.XX	±0.20
DIM	TOL
X.°	±2.0°
.X°	±1.0°
Angle	TOL

Drawn	22.09.2021	Peter
modification	Date	Name

Date: 22.09.2021
 Name: Peter
 Drawn: 22.09.2021
 Approved: 22.09.2021
 Peter
ASSMANN
 WSWW components

Description: Circular Connector
 Push Pull Self Lock / Male
 ASSMANN WSWW-NO.
A-CPPK-XX-MGMS-GHB01
 Drawing-No. ASS 9029 CO rev00
 Customer-No. SHEET 2 / 2