

1

2

3

4

5

6

7

A

A

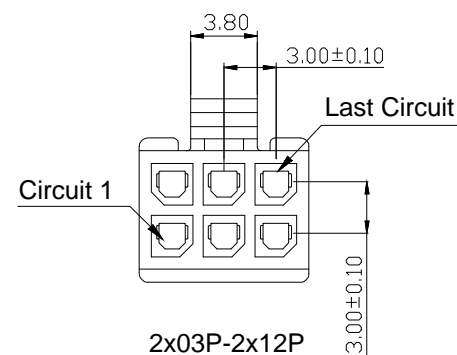

2x03P-2x12P

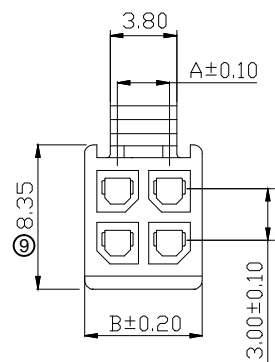

2x02P

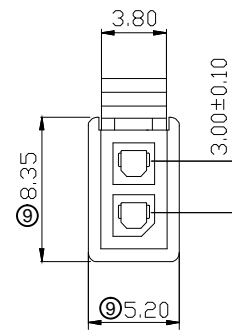

2x01P

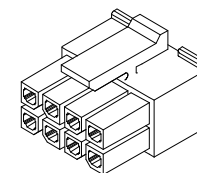

Notes:

Insulator Material: Nylon 66 UL94V-2 Black
 Voltage Rating: 250V AC,DC;
 Current Rating: 5A AC,DC;
 Withstanding Voltage: 1500V AC/minute;
 Insulation Resistance: 1000MΩ Min;
 Contact Resistance: 20mΩ Max;
 Operation Temperature: -25°C to +85°C;
 Packing: Bag.

B

B

C

C

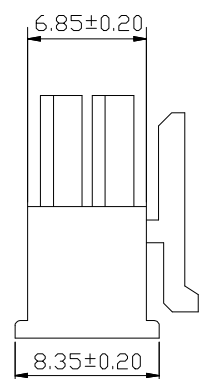
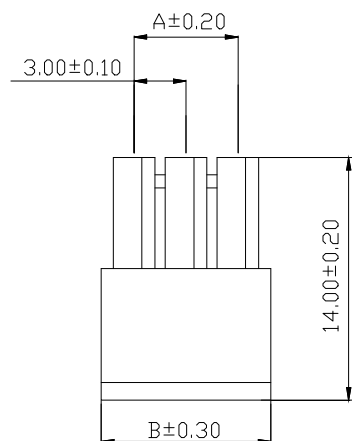

2x03P-2x12P

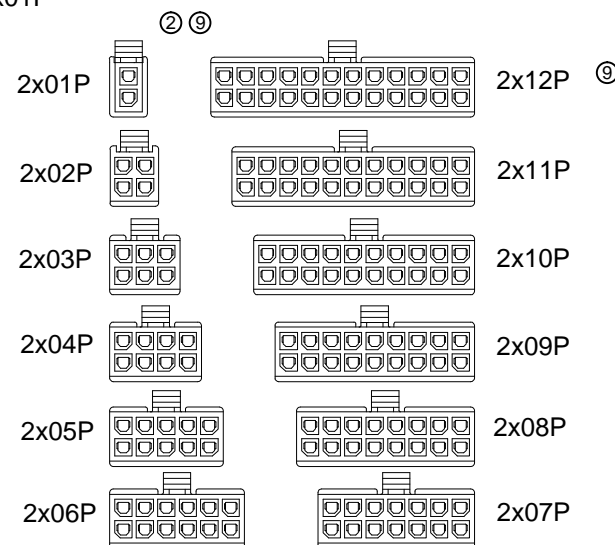

CIRCUIT SIZE LAYOUT

No. of Contact	DIM A	DIM B
2	NA	5.20
4	3.00	7.00
6	6.00	10.00
8	9.00	13.00
10	12.00	16.00
12	15.00	19.00
14	18.00	22.00
16	21.00	25.00
18	24.00	28.00
20	27.00	31.00
22	30.00	34.00
24	33.00	37.00

D

D

E

E

F

F

G

G

RoHS compliant

Unit:mm

Scale	Free	⑨	Update the Dimension and shape of the housing on page 1	10.20.2023	Peter		Date	Name
TOLERANCE		⑧	Add P/N :A-WBP-O001DA-xxSR02	07.26.2023	Winnie	Drawn	29.10.2021	Daniel
X.	±0.35	⑦	Add tape reel packing in page 8	06.14.2023	Winnie	Approved	10.20.2023	Peter
X.X	±0.25	⑥	Add LCP soldering profile	06.06.2023	Winnie			
X.XX	±0.20	⑤	Add page 8	04.18.2023	Winnie			
X.XXX	±0.15	④	Add UL E-No. on page 4,5,6,7	03.14.2023	Peter			
DIM	TOL	Id.	Modification	Date	Name			
Angle	TOL							

Description: Wire-to-board con.
Housing
Pitch 3.0mm / Straight

ASSMANN WSW-No.

A-WBH-O001DG-xxCB01

Drawing-No.

ASS 9062 CO

rev09

Customer-No.

SHEET
1 / 10

1

2

3

4

5

6

7

H

H

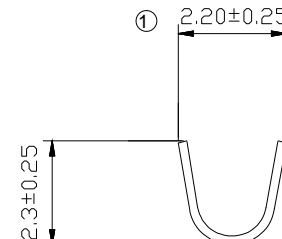
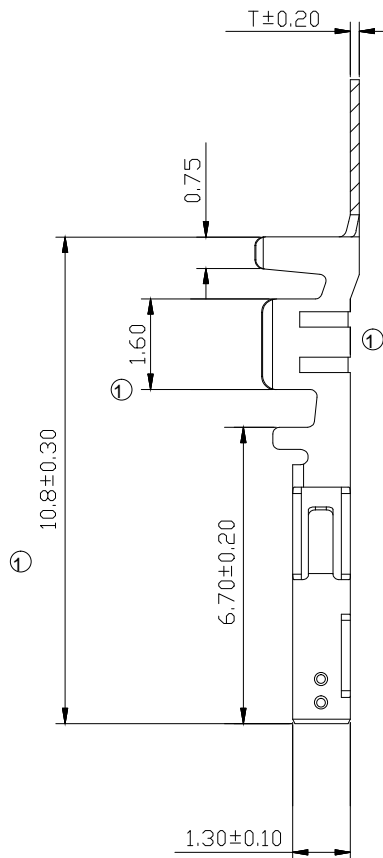
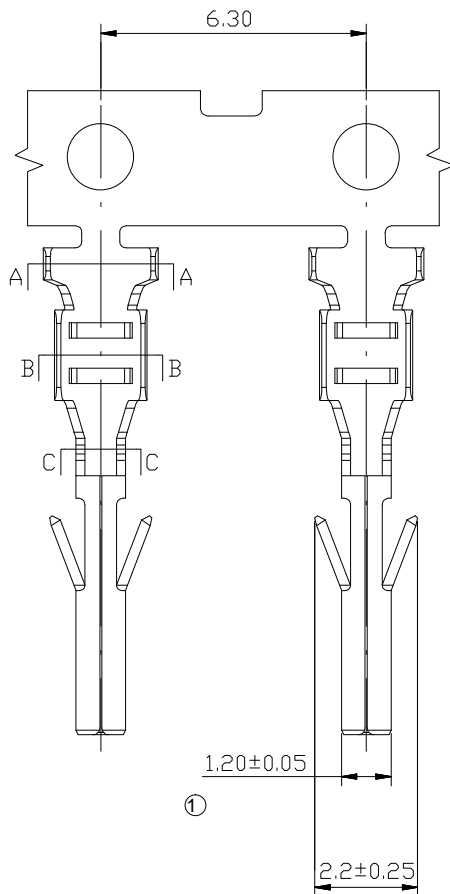

SEC A-A

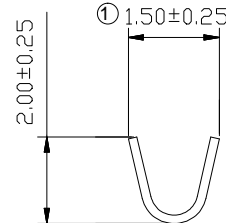

SEC B-B

Notes:
 Insulator Material: Phosphor Bronze;
 Finish: Tin Plated;
 Voltage Rating: 250V AC,DC;
 Current Rating: 5A AC,DC;
 Withstanding Voltage: 1500V AC/minute;
 Insulation Resistance: 1000MΩ Min;
 Contact Resistance: 20mΩ Max;
 Operation Temperature: -25°C to +85°C;
 Packing: Reel;
 Applicable wire: AWG#24-#28.

RoHS compliant
 Unit:mm

Scale	Free	⑨	Update the Dimension and shape of the housing on page 1	10.20.2023	Peter		Date	Name	Description: Wire-to-board con. Terminal Female
TOLERANCE		⑧	Add P/N :A-WBP-O001DA-xxSR02	07.26.2023	Winnie	Drawn	29.10.2021	Daniel	
X.	±0.35	⑦	Add tape reel packing in page 8	06.14.2023	Winnie	Approved	10.20.2023	Peter	
X.X	±0.25	⑥	Add LCP soldering profile	06.06.2023	Winnie				
X.XX	±0.20	⑤	Add page 8	04.18.2023	Winnie				
X.XXX	±0.15	④	Add UL E-No. on page 4,5,6,7	03.14.2023	Peter				
DIM	TOL	Id.	Modification	Date	Name				Drawing-No. ASS 9062 CO
Angle	TOL								Customer-No.

ASSMANN WSW-No.
A-WBT-O001EG-01CR01



Drawing-No. ASS 9062 CO
 rev09

Customer-No. SHEET 2 / 10

1

2

3

4

5

6

7

A

A

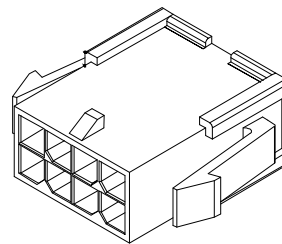
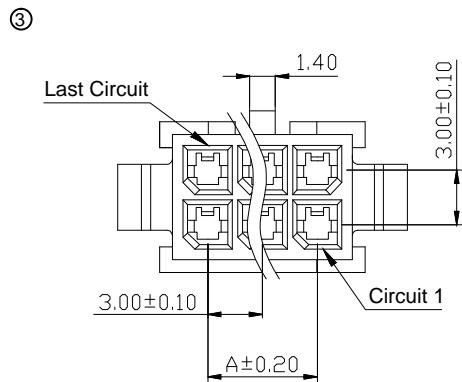

Notes:
 Insulator Material: Nylon 66 UL94V-2 Black
 Voltage Rating: 250V AC,DC;
 Current Rating: 5A AC,DC;
 Withstanding Voltage: 1500V AC/minute;
 Insulation Resistance: 1000MΩ Min;
 Contact Resistance: 20mΩ Max;
 Operation Temperature: -25°C to +85°C;
 Packing: Bag.

B

B

C

C

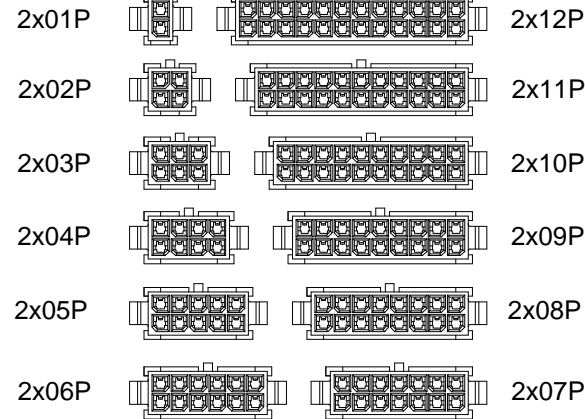
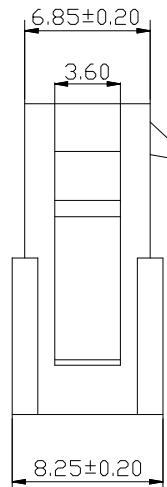
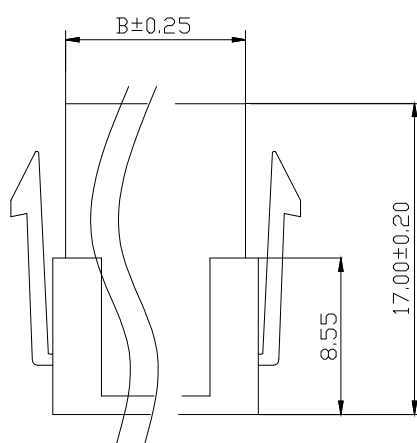

No. of Contact	DIM A	DIM B
2	NA	3.85
4	3.00	6.85
6	6.00	9.85
8	9.00	12.85
10	12.00	15.85
12	15.00	18.85
14	18.00	21.85
16	21.00	24.85
18	24.00	27.85
20	27.00	30.85
22	30.00	33.85
24	33.00	36.85

D

D

E

E

F

F

CIRCUIT SIZE LAYOUT

G

G

RoHS compliant

Unit:mm

Scale	Free	⑨	Update the Dimension and shape of the housing on page 1	10.20.2023	Peter		Date	Name
TOLERANCE		⑧	Add P/N :A-WBP-O001DA-xxSR02	07.26.2023	Winnie	Drawn	29.10.2021	Daniel
X.	±0.35	⑦	Add tape reel packing in page 8	06.14.2023	Winnie	Approved	10.20.2023	Peter
X.X	±0.25	⑥	Add LCP soldering profile	06.06.2023	Winnie			
X.XX	±0.20	⑤	Add page 8	04.18.2023	Winnie			
X.XXX	±0.15	④	Add UL E-No. on page 4,5,6,7	03.14.2023	Peter			
DIM	TOL	Id.	Modification	Date	Name			
Angle	TOL							

Description: Wire-to-board con. Housing Pitch 3.0mm / Straight

ASSMANN WSW-No. A-WBH-O001DG-xxCB02

Drawing-No. ASS 9062 CO rev09

Customer-No. SHEET 3 / 10

1

2

3

4

5

6

7

H

H

1

2

3

4

5

6

7

A

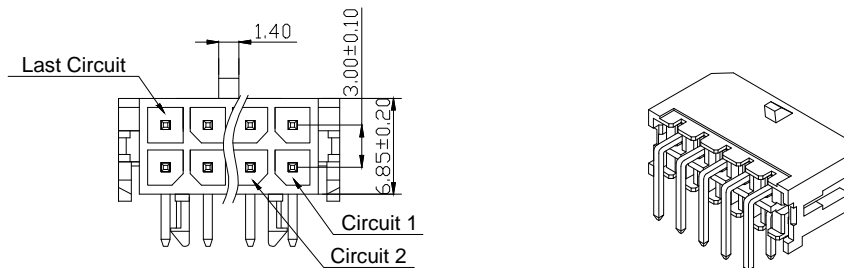

Notes:

Insulator Material:
 Contact Material:
 Voltage Rating:
 Current Rating:
 Withstanding Voltage:
 Insulation Resistance:
 Contact Resistance:
 Operation Temperature:
 Packing:

Nylon66+15%GF, UL94V-0, Black
 Brass, Tin plated
 250V AC,DC;
 5A AC,DC;
 1500V AC/minute;
 1000MΩ Min;
 20mΩ Max;
 -25°C to +85°C;
 PE bag.

B

C

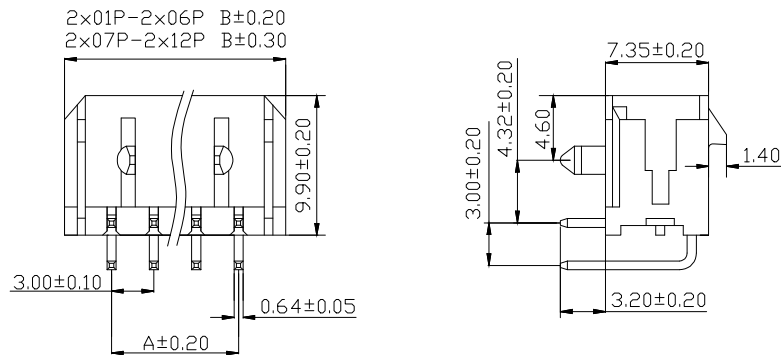

D

E

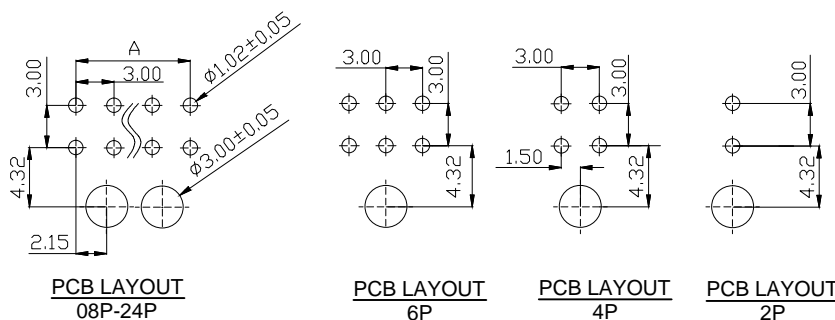

F

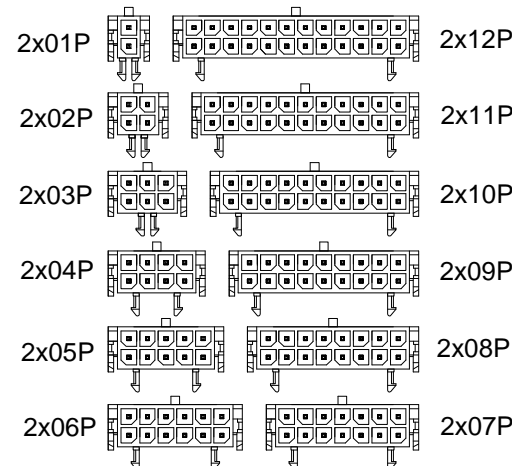

No. of Contact	DIM A	DIM B
2	NA	6.65
4	3.00	9.65
6	6.00	12.65
8	9.00	15.65
10	12.00	18.65
12	15.00	21.65
14	18.00	24.65
16	21.00	27.65
18	24.00	30.65
20	27.00	33.65
22	30.00	36.65
24	33.00	39.65

CIRCUIT SIZE LAYOUT

G

RoHS compliant

Unit:mm



④ File No.: E198287

Scale	Free
-------	------

TOLERANCE	
-----------	--

X.	±0.35
----	-------

X.X	±0.25
-----	-------

X.XX	±0.20
------	-------

X.XXX	±0.15
-------	-------

DIM	TOL
-----	-----

Angle	TOL
-------	-----

⑨	Update the Dimension and shape of the housing on page 1	10.20.2023	Peter
---	---	------------	-------

⑧	Add P/N :A-WBP-O001DA-xxSR02	07.26.2023	Winnie
---	------------------------------	------------	--------

⑦	Add tape reel packing in page 8	06.14.2023	Winnie
---	---------------------------------	------------	--------

⑥	Add LCP soldering profile	06.06.2023	Winnie
---	---------------------------	------------	--------

⑤	Add page 8	04.18.2023	Winnie
---	------------	------------	--------

④	Add UL E-No. on page 4,5,6,7	03.14.2023	Peter
---	------------------------------	------------	-------

Id.	Modification	Date	Name
-----	--------------	------	------

10.20.2023

Peter

Date

Name

Description: Wire-to-board con.
 Male
 Pitch 3.0mm / Angled

ASSMANN WSW-No.

A-WBP-O001DA-xxTB01

Drawing-No.

ASS 9062 CO

rev09

Customer-No.

SHEET 4 / 10

G

H

1

2

3

4

5

6

7

A

B

C

D

E

F

1

2

3

4

5

6

7

A

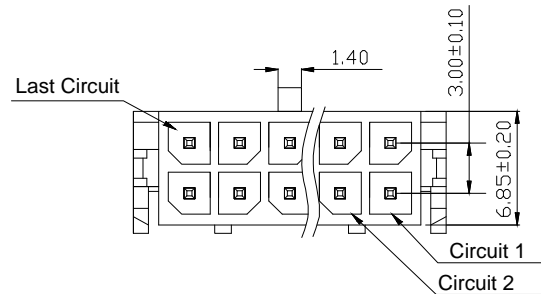

B

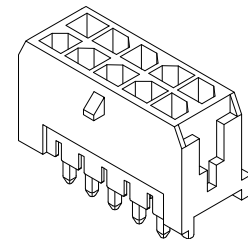

Notes:
 Insulator Material: LCP, UL94V-0, Black
 Contact Material: Brass, Tin plated
 Voltage Rating: 250V AC,DC;
 Current Rating: 5A AC,DC;
 Withstanding Voltage: 1500V AC/minute;
 Insulation Resistance: 1000MΩ Min;
 Contact Resistance: 20mΩ Max;
 Operation Temperature: -25°C to +85°C;
 Packing: PE bag.

A

B

C

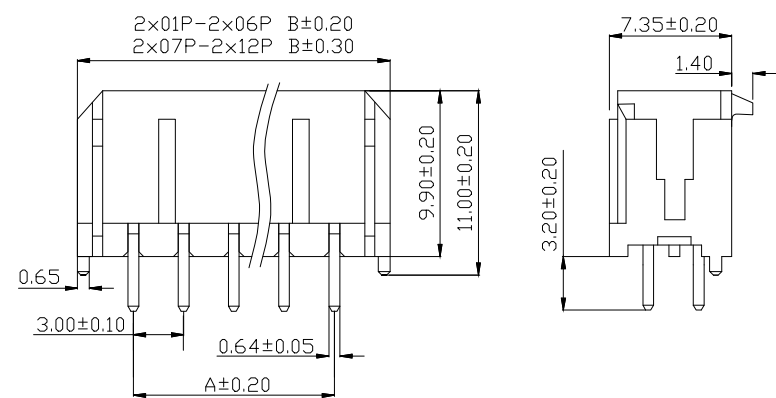

C

D

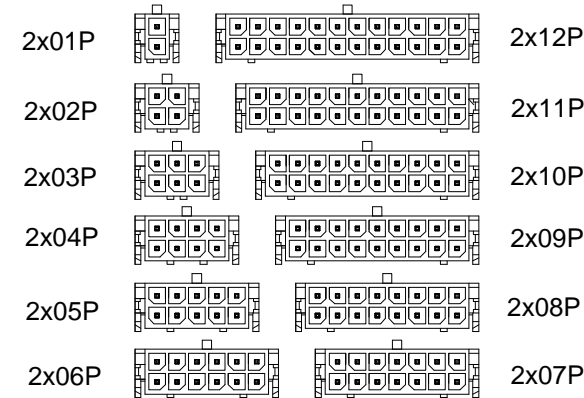

No. of Contact	DIM A	DIM B
2	NA	6.65
4	3.00	9.65
6	6.00	12.65
8	9.00	15.65
10	12.00	18.65
12	15.00	21.65
14	18.00	24.65
16	21.00	27.65
18	24.00	30.65
20	27.00	33.65
22	30.00	36.65
24	33.00	39.65

D

E

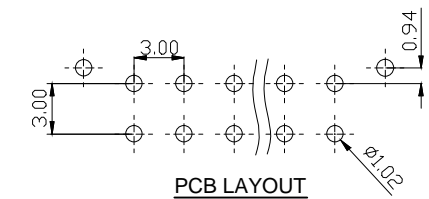

E

F

CIRCUIT SIZE LAYOUT

G

RoHS compliant

Unit:mm



④ File No.: E198287

Scale	Free	⑨	Update the Dimension and shape of the housing on page 1	10.20.2023	Peter		Date	Name
TOLERANCE		⑧	Add P/N :A-WBP-O001DA-xxSR02	07.26.2023	Winnie	Drawn	29.10.2021	Daniel
X.	±0.35	⑦	Add tape reel packing in page 8	06.14.2023	Winnie	Approved	10.20.2023	Peter
X.X	±0.25	⑥	Add LCP soldering profile	06.06.2023	Winnie			
X.XX	±0.20	⑤	Add page 8	04.18.2023	Winnie			
X.XXX	±0.15	④	Add UL E-No. on page 4,5,6,7	03.14.2023	Peter			
DIM	TOL							
Angle	TOL	Id.	Modification	Date	Name			

Description: Wire-to-board con.
 Male
 Pitch 3.0mm / Straight

ASSMANN WSW-No.
A-WBP-O001DG-xxTB01

Drawing-No.
ASS 9062 CO rev09

Customer-No. SHEET
 5 / 10

G

H

1

2

3

4

5

6

7

1

2

3

4

5

6

7

A

A

Notes:
 Insulator Material: LCP, UL94V-0, Black
 Contact Material: Brass, Tin plated
 Voltage Rating: 250V AC,DC;
 Current Rating: 5A AC,DC;
 Withstanding Voltage: 1500V AC/minute;
 Insulation Resistance: 1000MΩ Min;
 Contact Resistance: 20mΩ Max;
 Operation Temperature: -25°C to +85°C;
 Packing: Reel

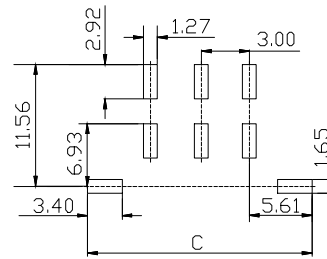
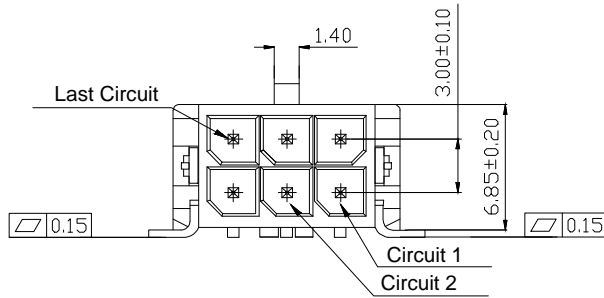
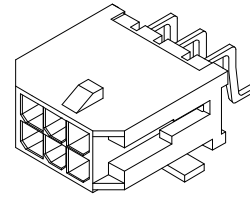

PCB LAYOUT

B

B

C

C

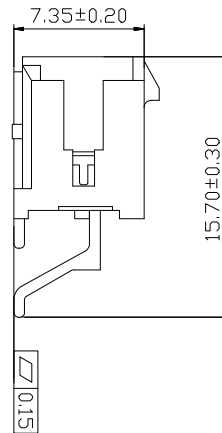
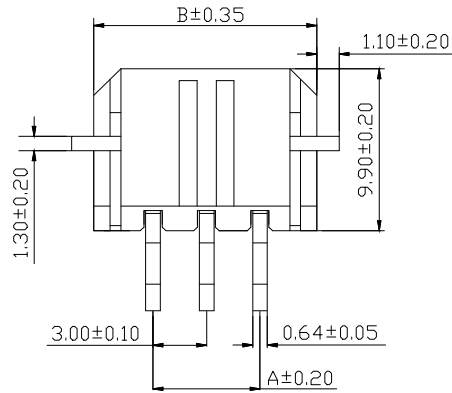

No. of Contact	DIM A	DIM B	DIM C
2	NA	6.65	11.20
4	3.00	9.65	14.20
6	6.00	12.65	17.20
8	9.00	15.65	20.20
10	12.00	18.65	23.20
12	15.00	21.65	26.20
14	18.00	24.65	29.20
16	21.00	27.65	32.20
18	24.00	30.65	35.20
20	27.00	33.65	38.20
22	30.00	36.65	41.20
24	33.00	39.65	44.20

D

D

E

E

F

F

G

G

RoHS compliant

Unit:mm



④ File No.: E198287

Scale	Free	⑨	Update the Dimension and shape of the housing on page 1	10.20.2023	Peter		Date	Name
TOLERANCE		⑧	Add P/N :A-WBP-O001DA-xxSR02	07.26.2023	Winnie	Drawn	29.10.2021	Daniel
X.	±0.35	⑦	Add tape reel packing in page 8	06.14.2023	Winnie	Approved	10.20.2023	Peter
X.X	±0.25	⑥	Add LCP soldering profile	06.06.2023	Winnie			
X.XX	±0.20	⑤	Add page 8	04.18.2023	Winnie			
X.XXX	±0.15	④	Add UL E-No. on page 4,5,6,7	03.14.2023	Peter			
DIM	TOL	Id.	Modification	Date	Name			
Angle	TOL							

Description: Wire-to-board con.
 Male,
 Pitch 3.0mm / Angled / SMT

ASSMANN WSW-No.
A-WBP-O001DA-xxSR01

Drawing-No.
ASS 9062 CO rev09

Customer-No. SHEET
 6 / 10

1

2

3

4

5

6

7

H

H

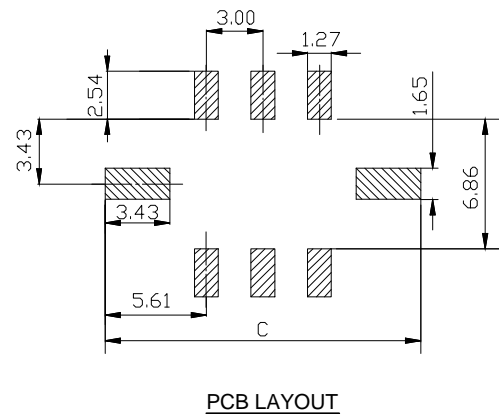
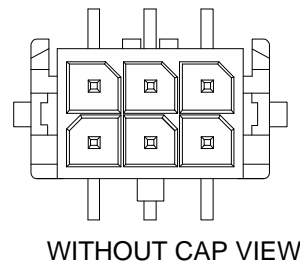
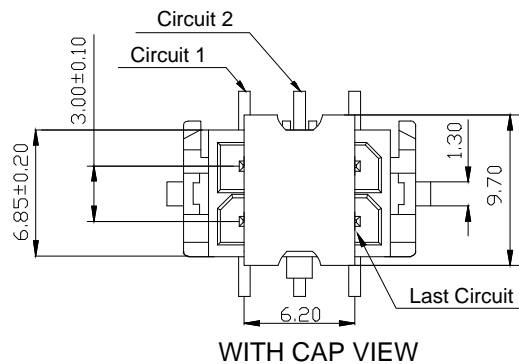

Notes:
 Insulator Material: LCP, UL94V-0, Black
 Contact Material: Brass, Tin plated
 Voltage Rating: 250V AC,DC;
 Current Rating: 5A AC,DC;
 Withstanding Voltage: 1500V AC/minute;
 Insulation Resistance: 1000MΩ Min;
 Contact Resistance: 20mΩ Max;
 Operation Temperature: -25°C to +85°C;
 Packing: Reel

No. of Contact	DIM A	DIM B	DIM C
2	NA	6.65	11.20
4	3.00	9.65	14.20
6	6.00	12.65	17.20
8	9.00	15.65	20.20
10	12.00	18.65	23.20
12	15.00	21.65	26.20
14	18.00	24.65	29.20
16	21.00	27.65	32.20
18	24.00	30.65	35.20
20	27.00	33.65	38.20
22	30.00	36.65	41.20
24	33.00	39.65	44.20

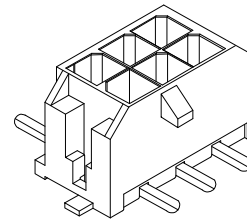
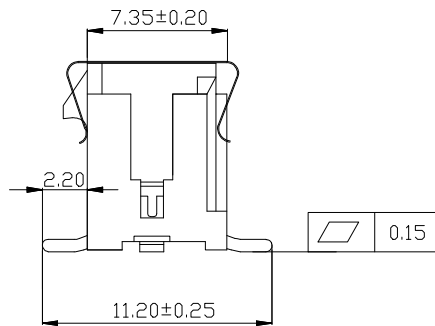
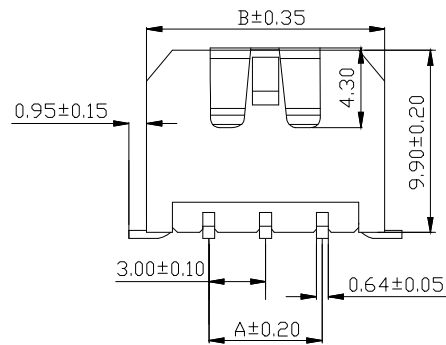

RoHS compliant
 Unit:mm

 ④ File No.: E198287

Scale	Free	⑨	Update the Dimension and shape of the housing on page 1	10.20.2023	Peter		Date	Name
TOLERANCE		⑧	Add P/N :A-WBP-O001DA-xxSR02	07.26.2023	Winnie	Drawn	29.10.2021	Daniel
X.	±0.35	⑦	Add tape reel packing in page 8	06.14.2023	Winnie	Approved	10.20.2023	Peter
X.X	±0.25	⑥	Add LCP soldering profile	06.06.2023	Winnie			
X.XX	±0.20	⑤	Add page 8	04.18.2023	Winnie			
X.XXX	±0.15	④	Add UL E-No. on page 4,5,6,7	03.14.2023	Peter			
DIM	TOL	Id.	Modification	Date	Name			
Angle	TOL							

Description: Wire-to-board con.
 Male
 Pitch 3.0mm / straight / SMT

ASSMANN WSW-No.
A-WBP-O001DG-xxSR01

Drawing-No.
ASS 9062 CO rev09

Customer-No. SHEET 7 / 10

1

2

3

4

5

6

7

1

2

3

4

5

6

7

A

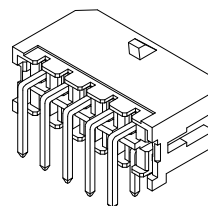
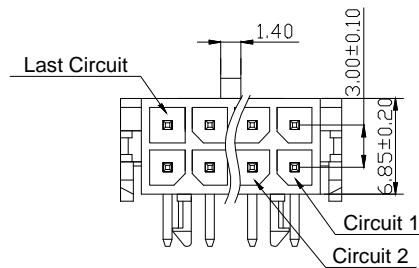

Notes:

Insulator Material: LCP+15%GF, UL94V-0, Black
 Contact Material: Brass, Tin plated
 Voltage Rating: 250V AC,DC;
 Current Rating: 5A AC,DC;
 Withstanding Voltage: 1500V AC/minute;
 Insulation Resistance: 1000MΩ Min;
 Contact Resistance: 20mΩ Max;
 Operation Temperature: -25°C to +85°C;
 Packing:
 A-WBP-O001DA-xxRP01:TRAY
 ⑦ A-WBP-O001DA-10RR01 :Tape Reel

A

B

B

C

C

2x01P-2x06P B±0.20
 2x07P-2x12P B±0.30

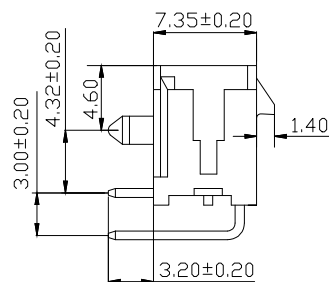
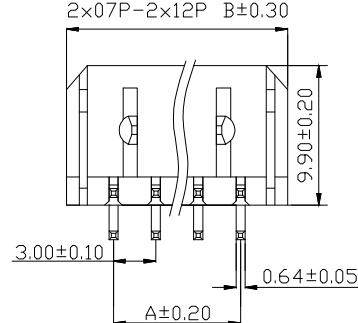

D

D

E

E

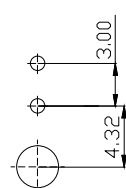
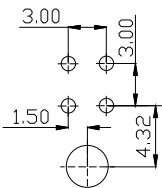
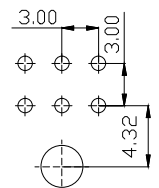
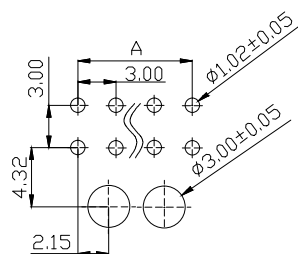
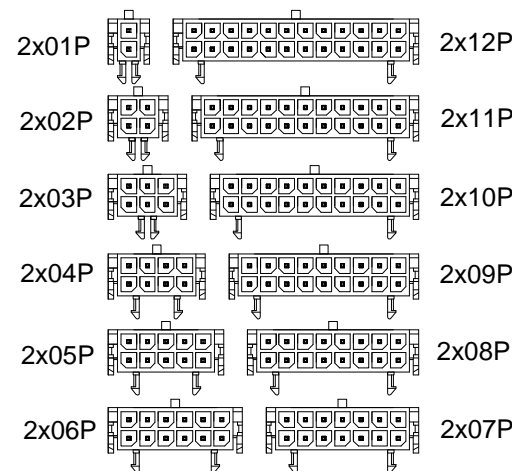
PCB LAYOUT
08P-24PPCB LAYOUT
6PPCB LAYOUT
4PPCB LAYOUT
2P

CIRCUIT SIZE LAYOUT

No. of Contact	DIM A	DIM B
2	NA	6.65
4	3.00	9.65
6	6.00	12.65
8	9.00	15.65
10	12.00	18.65
12	15.00	21.65
14	18.00	24.65
16	21.00	27.65
18	24.00	30.65
20	27.00	33.65
22	30.00	36.65
24	33.00	39.65

F

F

G

RoHS compliant

Unit:mm

Scale Free

TOLERANCE

X. ±0.35

X.X ±0.25

X.XX ±0.20

X.XXX ±0.15

DIM TOL

Angle TOL

⑨

Update the Dimension and shape of the housing on page 1

10.20.2023

Peter

Date

Name

Description: Wire-to-board con.
Male
Pitch 3.0mm / Angled /THR

⑧

Add P/N :A-WBP-O001DA-xxSR02

07.26.2023

Winnie

Drawn

29.10.2021

Daniel

⑦

Add tape reel packing in page 8

06.14.2023

Winnie

Approved

10.20.2023

Peter

ASSMANN WSW-No.

A-WBP-O001DA-xxRP01

⑥

Add LCP soldering profile

06.06.2023

Winnie

⑤

Add page 8

04.18.2023

Winnie

④

Add UL E-No. on page 4,5,6,7

03.14.2023

Peter

Drawing-No.

ASS 9062 CO

rev09

Customer-No.

SHEET
8 / 10

G

H

1

2

3

4

5

6

7

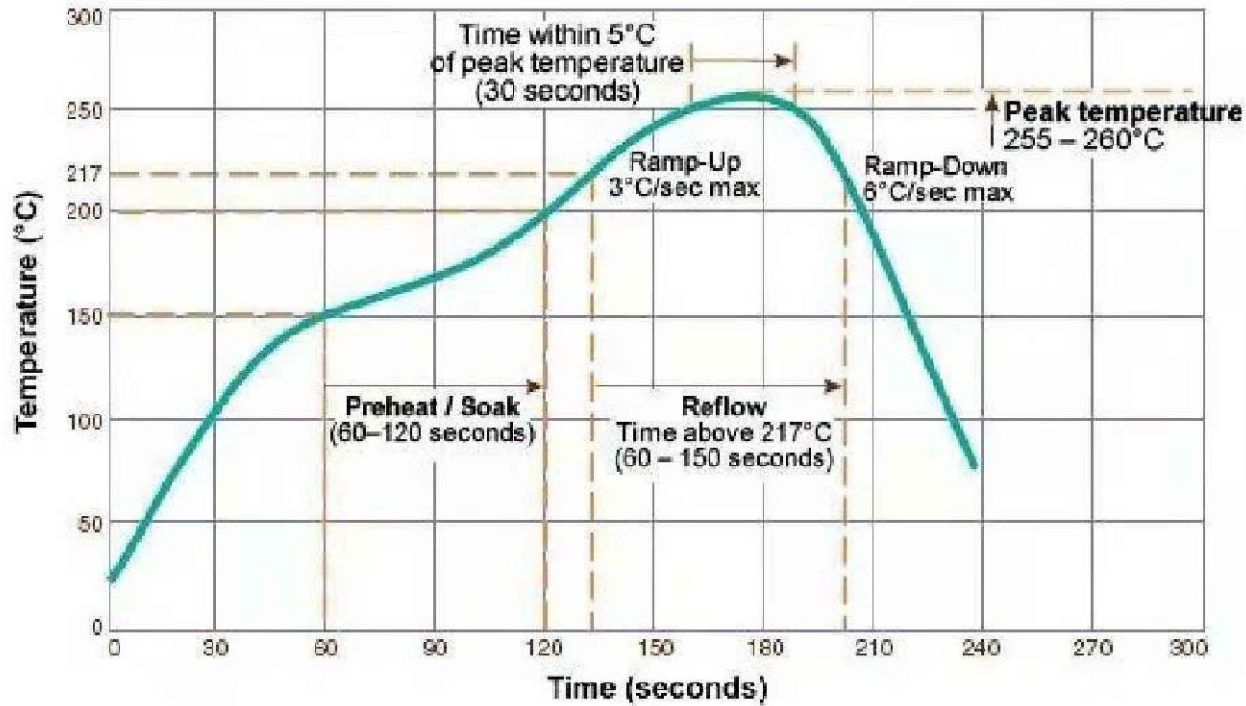

LCP Soldering Profile

RoHS compliant

Unit:mm

Scale	Free	⑨	Update the Dimension and shape of the housing on page 1	10.20.2023	Peter		Date	Name	Description: Wire-to-board con. Male Pitch 3.0mm
TOLERANCE		⑧	Add P/N :A-WBP-O001DA-xxSR02	07.26.2023	Winnie	Drawn	29.10.2021	Daniel	
X.	±0.35	⑦	Add tape reel packing in page 8	06.14.2023	Winnie	Approved	10.20.2023	Peter	
X.X	±0.25	⑥	Add LCP soldering profile	06.06.2023	Winnie				
X.XX	±0.20	⑤	Add page 8	04.18.2023	Winnie			Drawing-No. ASS 9062 CO	rev09
X.XXX	±0.15	④	Add UL E-No. on page 4,5,6,7	03.14.2023	Peter				
DIM	TOL	Id.	Modification	Date	Name	Customer-No.		SHEET 9 / 10	
Angle	TOL								



Drawing-No.
ASS 9062 CO
rev09

Customer-No.

SHEET
9 / 10

1

2

3

4

5

6

7

A

A

Notes:
 Insulator Material: LCP, UL94V-0, Black
 Contact Material: Brass, Tin plated
 Voltage Rating: 250V AC,DC;
 Current Rating: 5A AC,DC;
 Withstanding Voltage: 1500V AC/minute;
 Insulation Resistance: 1000MΩ Min;
 Contact Resistance: 20mΩ Max;
 ⑧ Operation Temperature: -40°C to +105°C;
 Packing: Reel

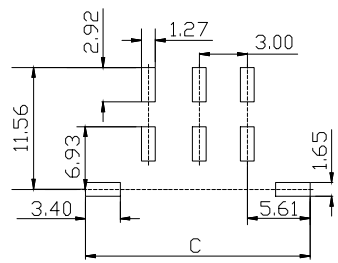
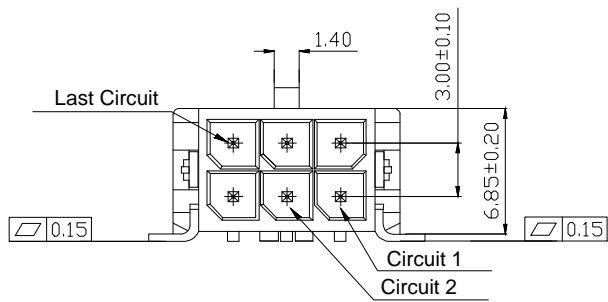
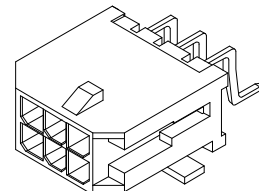

PCB LAYOUT

B

B

C

C

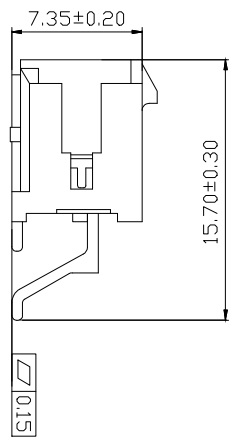
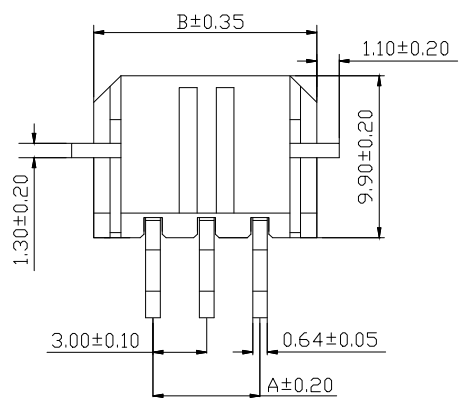

No. of Contact	DIM A	DIM B	DIM C
2	NA	6.65	11.20
4	3.00	9.65	14.20
6	6.00	12.65	17.20
8	9.00	15.65	20.20
10	12.00	18.65	23.20
12	15.00	21.65	26.20
14	18.00	24.65	29.20
16	21.00	27.65	32.20
18	24.00	30.65	35.20
20	27.00	33.65	38.20
22	30.00	36.65	41.20
24	33.00	39.65	44.20

D

D

E

E

F

F

RoHS compliant
 Unit:mm

Scale	Free	⑨	Update the Dimension and shape of the housing on page 1	10.20.2023	Peter		Date	Name
TOLERANCE		⑧	Add P/N :A-WBP-O001DA-xxSR02	07.26.2023	Winnie	Drawn	29.10.2021	Daniel
X.	±0.35	⑦	Add tape reel packing in page 8	06.14.2023	Winnie	Approved	07.26.2023	Peter
X.X	±0.25	⑥	Add LCP soldering profile	06.06.2023	Winnie			
X.XX	±0.20	⑤	Add page 8	04.18.2023	Winnie			
X.XXX	±0.15	④	Add UL E-No. on page 4,5,6,7	03.14.2023	Peter			
DIM	TOL	Id.	Modification	Date	Name			
Angle	TOL							

Description: Wire-to-board con.
 Male,
 Pitch 3.0mm / Angled / SMT

ASSMANN WSW-No.
A-WBP-O001DA-xxSR02

Drawing-No.
ASS 9062 CO rev09

Customer-No. SHEET
 10 / 10

G

G

H

H

1

2

3

4

5

6

7