

1

2

3

4

5

6

7

A

A

B

B

C

C

D

D

E

E

F

F

G

G

H

H

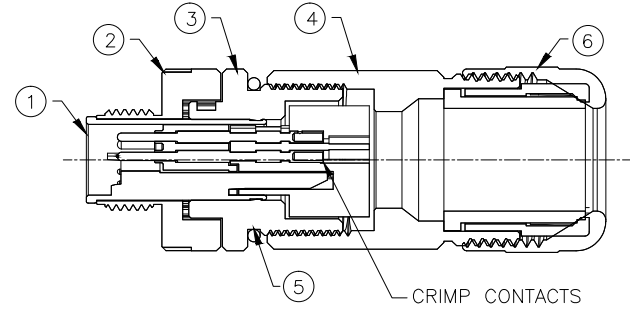
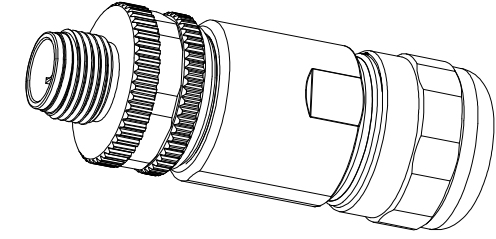
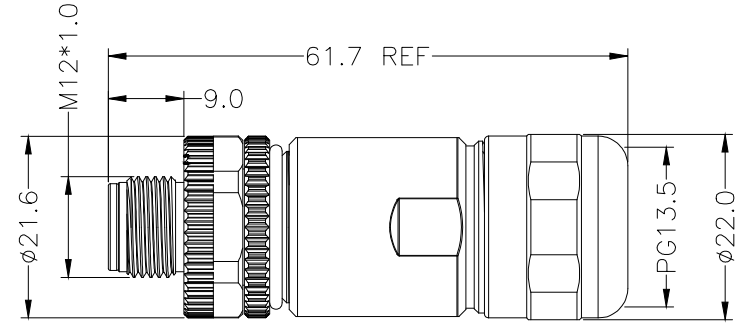
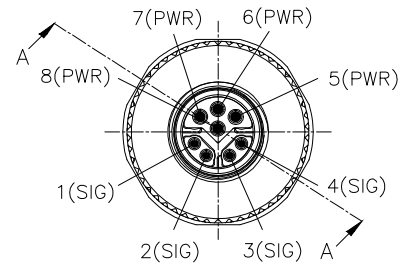

SECTION A-A

Detailed Product Description:  
 Waterproof connector rating is IP67  
 They can not be used permanently under water

Connector Electrical Characteristics:  
 Rating voltage: 60V AC/DC  
 Insulation resistance: >100MΩ  
 Rating current: 6A (POWER) / 0.5A (SIGNAL)  
 Contact resistance of connector: ≤10mΩ  
 Mechanical characteristics: mating/cycle: >100cycle  
 Operating temperature: -25°C ~ +85°C  
 Cable OD: 8~11mm  
 AWG: 20AWG (POWER) / 24AWG (SIGNAL)

⑥	PG13.5 METAL WATERPROOF CABLE JOINT	1	SET
⑤	O-RING GREEN FKM $\varnothing 15.0 \times 1.5$ MM	1	PCS
④	M12 NICKEL PLATED BRASS BODY SHELL	1	PCS
③	M12 NICKEL PLATED BRASS SHELL	1	PCS
②	M12 NICKEL PLATED BRASS MALE SHELL (M12*1.0)	1	PCS
①	M12 Y CODING 8PIN(4+4) MALE CONNECTOR	1	SET
ITEM	SPECIFICATION	Q'TY	UNIT

G	RoHS compliant unit:mm	Scale	Free	Date	Name	Description: Circular Connector M12 Male Y-Code				
		TOLERANCE					Drawn	24.11.2021	Luca	
		.X	±0.50				Approved	29.06.2022	Luca	
		.XX	±0.20							
DIM	TOL			ASSMANN WSW-NO. A-M12-08-MGMY-GCB1						
H		.X°	±1.0°	Date	Name	Drawing-No. ASS 9091 CO rev01				
		X.°	±2.0°				ASSMANN WSW components	Customer-No.	SHEET 1 / 2	
		Angle	TOL							①
							②	Drawn	24.11.2021	Luca
		Id.	modification	Date	Name					

1

2

3

4

5

6

7

# Installation Introduction

1. Recommended Cable OD: 8-11mm
2. Recommended Core Wire:  
Data: 26AWG Power: 20AWG
3. Recommended Cable Stripping: 15mm
4. Recommended Core Wire Stripping: 4mm
5. The terminal should be pressed with crimping pliers like below tooling:

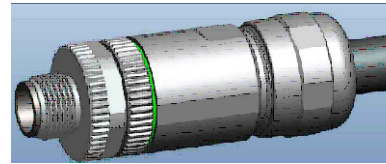

Schematic Diagram of Assembled Product



## 6. Installation Process:

6.1 the cable is inserted into the waterproof throat part

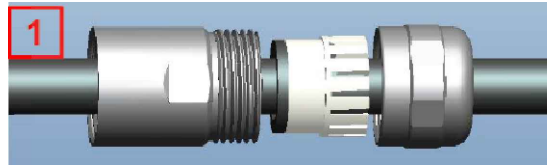

6.2 Cable Stripping

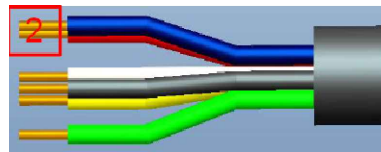

6.3 Crimping terminals

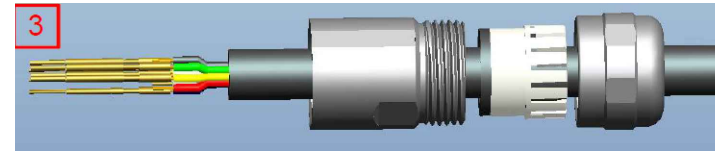

6.4 Snap the terminals into the rubber core

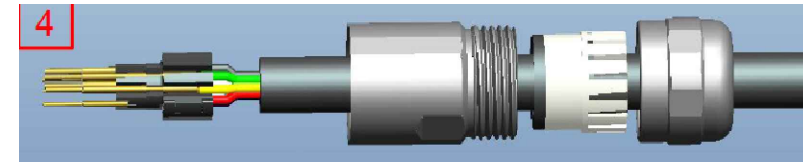

6.5 Insert the terminal assembly into the housing (note the orientation)

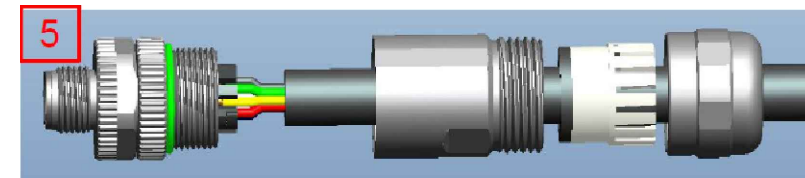

6.6 Tighten the housing and tail nut in turn

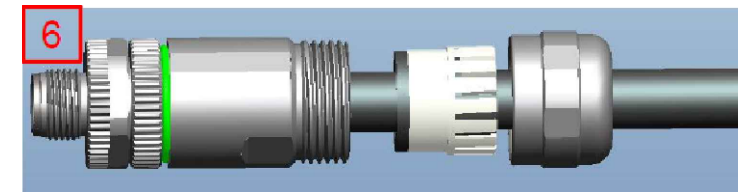

RoHS compliant

unit:mm

Scale Free

TOLERANCE

.X ±0.50

.XX ±0.20

DIM TOL

.X° ±1.0°

X.° ±2.0°

Angle TOL

① Add page 2 for installation introduction 29.06.2022 Luca

② Drawn 24.11.2021 Luca

Id. modification Date Name

Date Name

Drawn 24.11.2021 Luca

Approved 29.06.2022 Luca

**ASSMANN**  
WSW components

Description: Circular Connector  
M12 Male Y-Code

ASSMANN WSW-NO.  
**A-M12-08-MGMY-GCB1**

Drawing-No.  
**ASS 9091 CO** rev01

Customer-No. SHEET  
2 / 2