

SEC A-A

- NOTE:
- MATERIAL
 - Housing: PBT+GF JLG4V-0-Black
 - Contact: C2680, Au or Tin over Nickel
 - ELECTRIC
 - Contact Resistance: 30 Milliohms Max.
 - Insulation Resistance: 1000 Mega Ohms Min.
 - Dielectric Voltage: 500V AC one Sec Level.
 - Operating Temperature: -55°C To +105°C
 - Packing: Tray
- Order Code: A-BAT-CH-C8-EA-xTP1

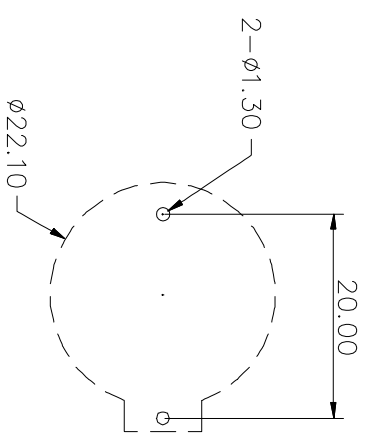
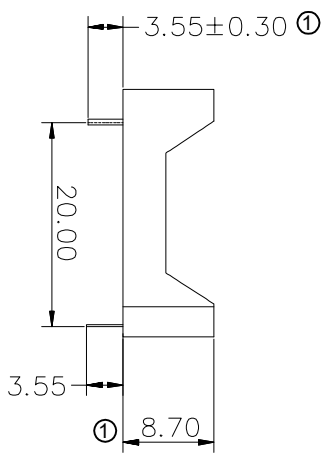

PCB HOLE LAYOUT

Scale	Free						
TOLERANCE							
X.	±0.35				Drawn	12.19.2021	Peter
.X	±0.25				Approved	12.06.2023	Winnie
.XX	±0.20						
.XXX	±0.15	①	Update the dimensions	12.06.2023			Winnie
DIM	TOL	②	Drawn	12.19.2021			Peter
Angle	TOL		modification				

Description:		Coin Cell Holders	
		CR2032 Type	
ASSMANN WSW-NO.		A-BAT-CH-C8-EA-xTP1	
Drawing-No.	ASS 9155 CO	rev01	
Customer-No.		SHEET	1 / 1

1		2		3		4		5		6		7	
<p>ROHS compliant</p> <p>unit:mm</p>													
<p>1</p>													