

1

2

3

4

5

6

7

A

A

NOTE:

1.MATERIAL

- 1.1 Insulator:Nylon 66,UL94V-0,Gray
- 1.2 Contact:Brass,Tin over Nickel

2.ELECTRIC

- 2.1 Voltage Rating:150V AC/DC
- 2.2 Current Rating:1A AC/DC
- 2.3 Withstanding Voltage:500V AC/minute
- 2.4 Insulation Resistance:500MQ Min

3.Temperature Range:-40°C To +105°C

4.Packing:PE bag

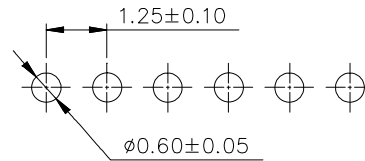
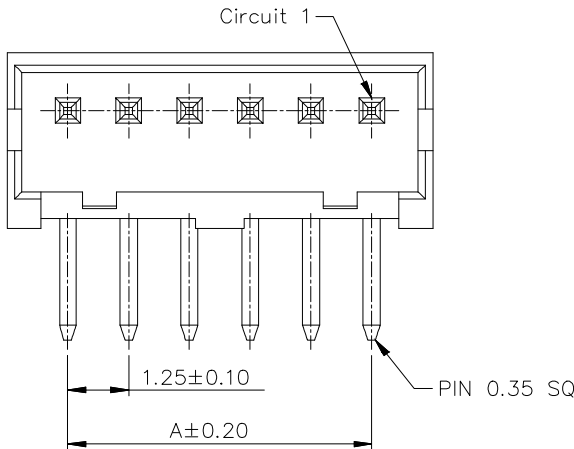

P.C.B LAYOUT

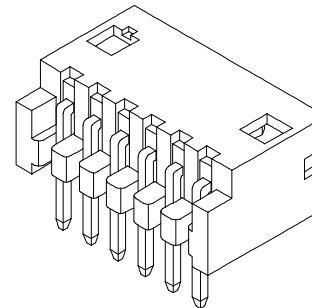

B

B

C

C

D

D

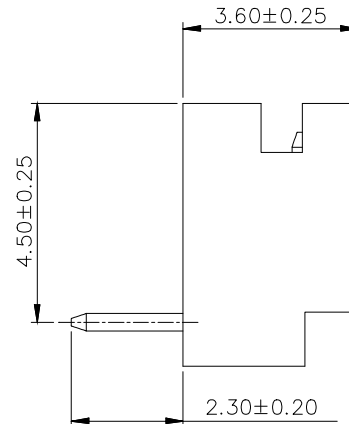
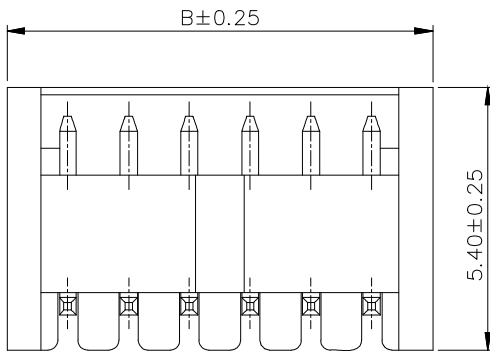

Poles	Part No.	Dimensions (mm)	
		A	B
02	A-WBP-D004EA-02TB01	1.25	3.75
03	A-WBP-D004EA-03TB01	2.50	5.00
04	A-WBP-D004EA-04TB01	3.75	6.25
05	A-WBP-D004EA-05TB01	5.00	7.50
06	A-WBP-D004EA-06TB01	6.25	8.75
07	A-WBP-D004EA-07TB01	7.50	10.00
08	A-WBP-D004EA-08TB01	8.75	11.25
09	A-WBP-D004EA-09TB01	10.00	12.50
10	A-WBP-D004EA-10TB01	11.25	13.75
11	A-WBP-D004EA-11TB01	12.50	15.00
12	A-WBP-D004EA-12TB01	13.75	16.25
13	A-WBP-D004EA-13TB01	15.00	17.50
14	A-WBP-D004EA-14TB01	16.25	18.75
15	A-WBP-D004EA-15TB01	17.50	20.00

E

E

F

F

G

G

RoHS compliant
unit:mm

Scale Free

TOLERANCE

X. ±0.35

X.X ±0.25

X.XX ±0.20

X.XXX ±0.15

DIM TOL

Angle TOL

②

Update the housing color

10.27.2022

Peter

①

Update the housing color and terminal material strip

06.17.2022

Peter

③

Drawn

01.08.2022

Peter

Id.

modification

Date

Name

Date

Name

Drawn

01.08.2022

Peter



Description: Wire to Board Wafer
Pitch 1.25mm 90° THT

ASSMANN WSW-NO.

A-WBP-D004EA-xxTB01

Drawing-No.

ASS 9200 CO

rev02

Customer-No.

SHEET
1 / 8

1

2

3

4

5

6

7

1

2

3

4

5

6

7

A

B

C

D

E

F

A

B

C

D

E

F

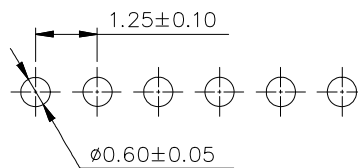
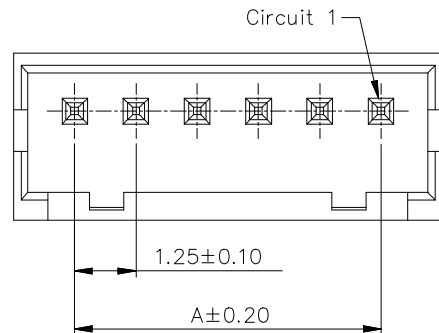

P.C.B LAYOUT

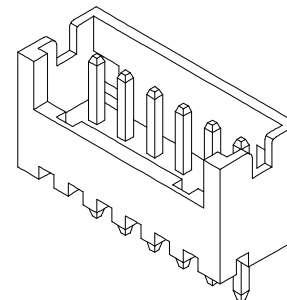

NOTE:

1.MATERIAL

- 1.1 Insulator:Nylon 66,UL94V-0,Gray
- 1.2 Contact:Brass,Tin over Nickel

2.ELECTRIC

- 2.1 Voltage Rating:150V AC/DC
- 2.2 Current Rating:1A AC/DC
- 2.3 Withstanding Voltage:500V AC/minute
- 2.4 Insulation Resistance:500MΩ Min

3.Temperature Range:-40°C To +105°C

4.Packing:PE bag

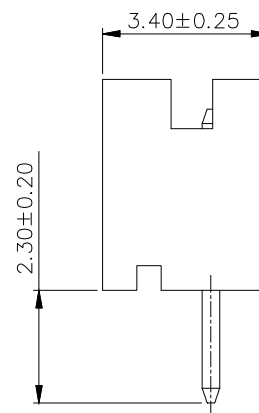
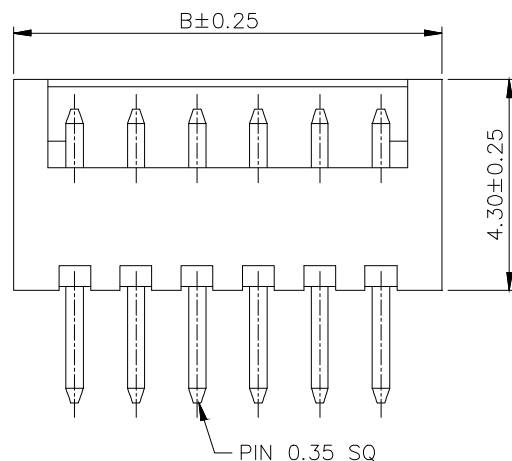

Poles	Part No.	Dimensions (mm)	
		A	B
02	A-WBP-D004EG-02TB01	1.25	3.75
03	A-WBP-D004EG-03TB01	2.50	5.00
04	A-WBP-D004EG-04TB01	3.75	6.25
05	A-WBP-D004EG-05TB01	5.00	7.50
06	A-WBP-D004EG-06TB01	6.25	8.75
07	A-WBP-D004EG-07TB01	7.50	10.00
08	A-WBP-D004EG-08TB01	8.75	11.25
09	A-WBP-D004EG-09TB01	10.00	12.50
10	A-WBP-D004EG-10TB01	11.25	13.75
11	A-WBP-D004EG-11TB01	12.50	15.00
12	A-WBP-D004EG-12TB01	13.75	16.25
13	A-WBP-D004EG-13TB01	15.00	17.50
14	A-WBP-D004EG-14TB01	16.25	18.75
15	A-WBP-D004EG-15TB01	17.50	20.00

G

RoHS compliant
unit:mm

Scale	Free
TOLERANCE	
X.	±0.35
X.X	±0.25
X.XX	±0.20
X.XXX	±0.15
DIM	TOL
Angle	TOL

Id.	modification	Date	Name
②	Update the housing color	10.27.2022	Peter
①	Update the housing color and terminal material strip	06.17.2022	Peter
①	Drawn	01.08.2022	Peter

ASSMANN
WSW components

Date

Name

Drawn

Approved

01.08.2022

10.27.2022

Peter

Peter

Description: Wire to Board Wafer
Pitch 1.25mm 180° THT

ASSMANN WSW-NO.

A-WBP-D004EG-xxTB01

Drawing-No.

ASS 9200 CO

rev02

Customer-No.

SHEET
2 / 8

1

2

3

4

5

6

7

SV4422

1

2

3

4

5

6

7

A

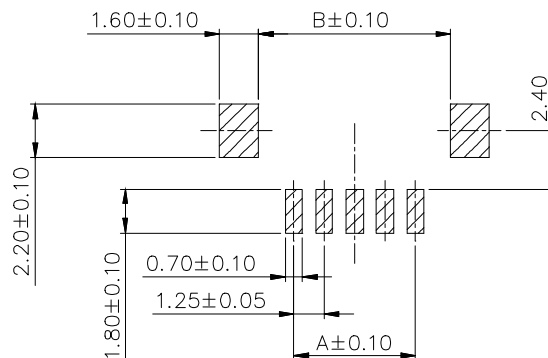
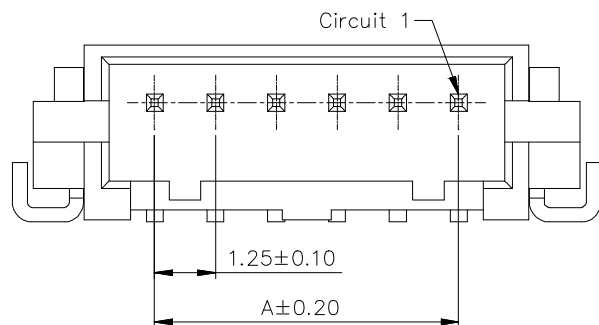

P.C.B LAYOUT

NOTE:

- 1.MATERIAL**
 1.1 Insulator:Nylon 6T,UL94V-0,Ivory
 1.2 Contact:Brass,Tin over Nickel
 1.3 Solder Tabs:Phosphor Bronze,Tin over Nickel
- 2.ELECTRIC**
 2.1 Voltage Rating:150V AC/DC
 2.2 Current Rating:1A AC/DC
 2.3 Withstanding Voltage:500V AC/minute
 2.4 Insulation Resistance:500MΩ Min
- 3.Temperature Range:-40°C To +105°C**
4.Packing:Reel

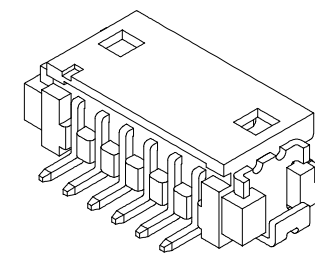

C

D

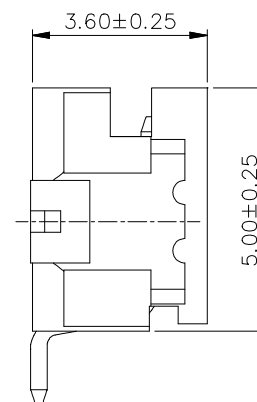
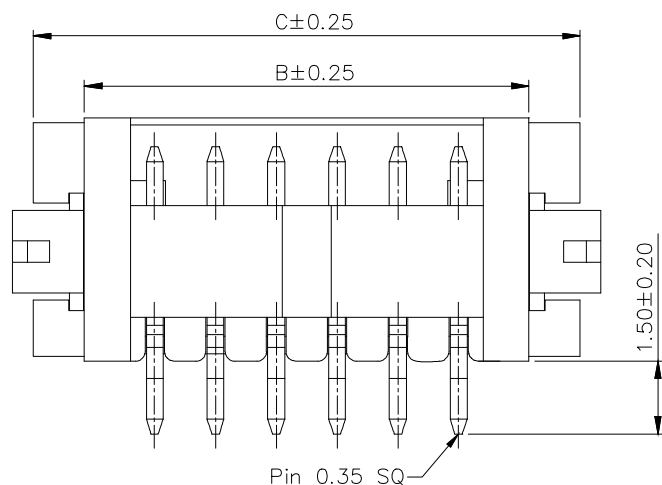

E

F

Poles	Part No.	Dimensions (mm)		
		A	B	C
02	A-WBP-D004EA-02SR01	1.25	4.15	6.25
03	A-WBP-D004EA-03SR01	2.50	5.40	7.50
04	A-WBP-D004EA-04SR01	3.75	6.65	8.75
05	A-WBP-D004EA-05SR01	5.00	7.90	10.00
06	A-WBP-D004EA-06SR01	6.25	9.15	11.25
07	A-WBP-D004EA-07SR01	7.50	10.40	12.50
08	A-WBP-D004EA-08SR01	8.75	11.65	13.75
09	A-WBP-D004EA-09SR01	10.00	12.90	15.00
10	A-WBP-D004EA-10SR01	11.25	14.15	16.25
11	A-WBP-D004EA-11SR01	12.50	15.40	17.50
12	A-WBP-D004EA-12SR01	13.75	16.65	18.75
13	A-WBP-D004EA-13SR01	15.00	17.90	20.00
14	A-WBP-D004EA-14SR01	16.25	19.15	21.25
15	A-WBP-D004EA-15SR01	17.50	20.40	22.50

G

RoHS compliant
unit:mm

Scale Free

TOLERANCE

X. ±0.35

X.X ±0.25

X.XX ±0.20

X.XXX ±0.15

DIM TOL

Angle TOL

Id.

modification

Date

Name

Date

Name

Description: Wire to Board Wafer
Pitch 1.25mm 90° SMT

ASSMANN WSW-NO.

A-WBP-D004EA-xxSR01

Drawing-No.

ASS 9200 CO

rev02

Customer-No.

SHEET
3 / 8

H

A

B

C

D

E

F

G

H

1

2

3

4

5

6

7

SV4422

1

2

3

4

5

6

7

NOTE:

1.MATERIAL

- 1.1 Insulator:Nylon 6T,UL94V-0,Ivory
- 1.2 Contact:Brass,Tin over Nickel

2.ELECTRIC

- 2.1 Voltage Rating:150V AC/DC
- 2.2 Current Rating:1A AC/DC
- 2.3 Withstanding Voltage:500V AC/minute
- 2.4 Insulation Resistance:500MΩ Min

3.Temperature Range:-40°C To +105°C

4.Packing:Reel

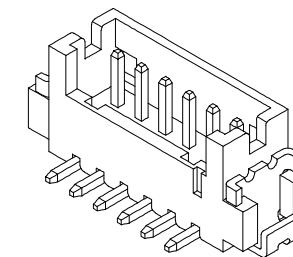

Cap(For Pick And Place Systems)

Circuit 1

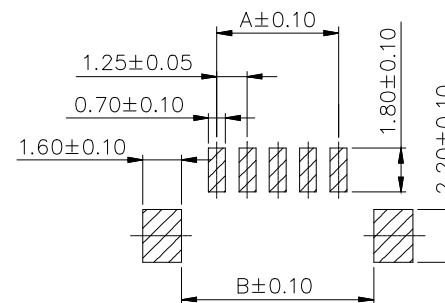
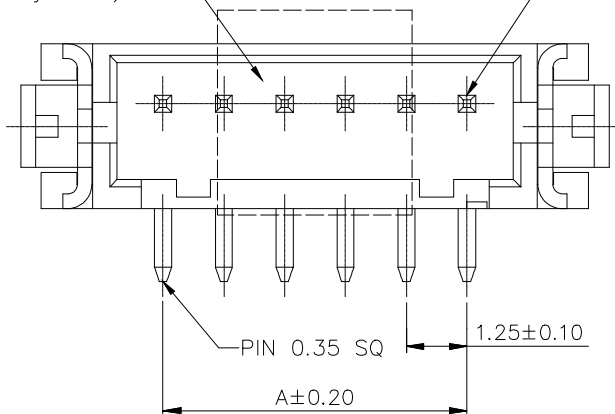

P.C.B LAYOUT

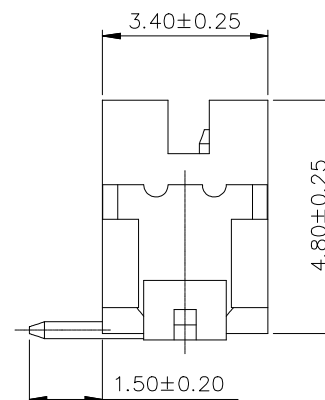
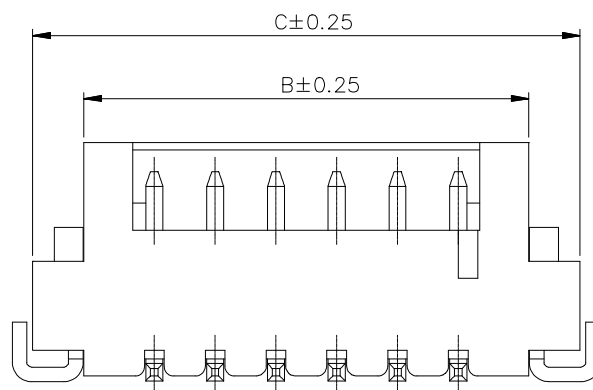

Poles	Part No.	Dimensions (mm)		
		A	B	C
02	A-WBP-D004EG-02SR01	1.25	4.15	6.25
03	A-WBP-D004EG-03SR01	2.50	5.40	7.50
04	A-WBP-D004EG-04SR01	3.75	6.65	8.75
05	A-WBP-D004EG-05SR01	5.00	7.90	10.00
06	A-WBP-D004EG-06SR01	6.25	9.15	11.25
07	A-WBP-D004EG-07SR01	7.50	10.40	12.50
08	A-WBP-D004EG-08SR01	8.75	11.65	13.75
09	A-WBP-D004EG-09SR01	10.00	12.90	15.00
10	A-WBP-D004EG-10SR01	11.25	14.15	16.25
11	A-WBP-D004EG-11SR01	12.50	15.40	17.50
12	A-WBP-D004EG-12SR01	13.75	16.65	18.75
13	A-WBP-D004EG-13SR01	15.00	17.90	20.00
14	A-WBP-D004EG-14SR01	16.25	19.15	21.25
15	A-WBP-D004EG-15SR01	17.50	20.40	22.50

RoHS compliant

unit:mm

Scale Free

TOLERANCE

X. ±0.35

X.X ±0.25

X.XX ±0.20

X.XXX ±0.15

DIM TOL

Angle TOL

② Update the housing color 10.27.2022 Peter

① Update the housing color and terminal material strip 06.17.2022 Peter

① Drawn 01.08.2022 Peter

① modification Date Name

Date

Name

Description: Wire to Board Wafer

Pitch 1.25mm 180° SMT

Drawn

01.08.2022

Peter

Approved

10.27.2022

Peter

ASSMANN WSW-NO.

A-WBP-D004EG-xxSR01

Drawing-No.

ASS 9200 CO

rev02

Customer-No.

SHEET

4 / 8

1

2

3

4

5

6

7

SV4422

1

2

3

4

5

6

7

A

A

NOTE:

1.MATERIAL

① 1.1 Insulator:Nylon 66,UL94V-0,Brown

2.ELECTRIC

2.1 Voltage Rating:150V AC/DC

2.2 Current Rating:1A AC/DC

2.3 Withstanding Voltage:500V AC/minute

2.4 Insulation Resistance:500MΩ Min

3.Temperature Range:-40°C To +105°C

4.Packing:PE bag

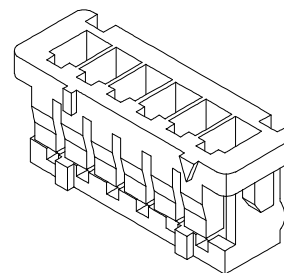
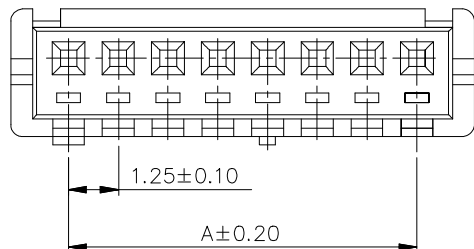

B

B

C

C

D

D

E

E

F

F

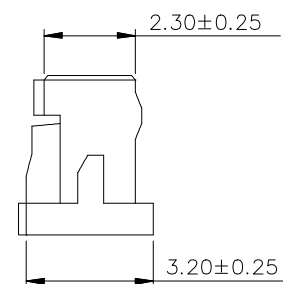
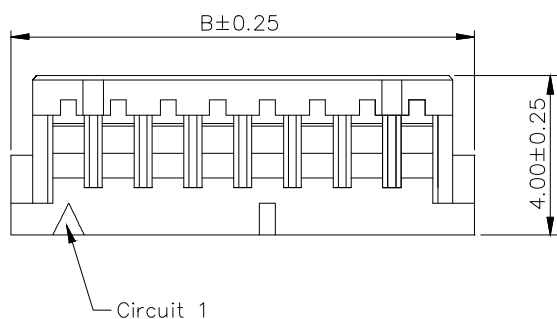

Poles	Part No.	Dimensions (mm)	
		A	B
02	A-WBH-D004EG-02CB01	1.25	4.15
03	A-WBH-D004EG-03CB01	2.50	5.40
04	A-WBH-D004EG-04CB01	3.75	6.65
05	A-WBH-D004EG-05CB01	5.00	7.90
06	A-WBH-D004EG-06CB01	6.25	9.15
07	A-WBH-D004EG-07CB01	7.50	10.40
08	A-WBH-D004EG-08CB01	8.75	11.65
09	A-WBH-D004EG-09CB01	10.00	12.90
10	A-WBH-D004EG-10CB01	11.25	14.15
11	A-WBH-D004EG-11CB01	12.50	15.40
12	A-WBH-D004EG-12CB01	13.75	16.65
13	A-WBH-D004EG-13CB01	15.00	17.90
14	A-WBH-D004EG-14CB01	16.25	19.15
15	A-WBH-D004EG-15CB01	17.50	20.40

G

G

RoHS compliant

unit:mm

Scale Free

TOLERANCE

X. ±0.35

X.X ±0.25

X.XX ±0.20

X.XXX ±0.15

DIM TOL

Angle TOL

Id.

modification

Date

Name

Date

Name

Description: Wire to Board Housing
Pitch 1.25mm

ASSMANN WSW-NO.

A-WBH-D004EG-xxCB01

Drawing-No.

ASS 9200 CO

rev02

Customer-No.

SHEET
5 / 8

H

H

1

2

3

4

5

6

7

SV4422

1

2

3

4

5

6

7

A

A

B

B

C

C

D

D

E

E

F

F

NOTE:

1.MATERIAL
1.1 Contact: Phosphor Bronze, Tin over Nickel

2.ELECTRIC
2.1 Voltage Rating:150V AC/DC
2.2 Current Rating:1A AC/DC
2.3 Withstanding Voltage:500V AC/minute
2.4 Insulation Resistance:500MΩ Min
2.5 Contact Resistance:30mΩ Max

3.Temperature Range:-40°C To +105°C
4.Applicable Wire:AWG#26-#30
5.Packing:Reel

SEC:A-A

SEC:B-B

G

G

RoHS compliant
unit:mm

Scale	Free
TOLERANCE	
X.	±0.35
X.X	±0.25
X.XX	±0.20
X.XXX	±0.15
DIM	TOL
Angle	TOL

②	Update the housing color	10.27.2022	Peter
①	Update the housing color and terminal material strip	06.17.2022	Peter
①	Drawn	01.08.2022	Peter
Id.	modification	Date	Name

Drawn	01.08.2022	Peter
Approved	10.27.2022	Peter

ASSMANN
WSW components

Description: Wire to Board Terminal Pitch 1.25mm	
ASSMANN WSW-NO. A-WBT-D004EG-01CR01	
Drawing-No. ASS 9200 CO	rev02
Customer-No.	SHEET 6 / 8

H

H

1

2

3

4

5

6

7

SV4422

1

2

3

4

5

6

7

A

A

NOTE:**1.MATERIAL**

- 1.1 Insulator:Nylon 6T,UL94V-0,Ivory
- 1.2 Cap:Nylon 6T,UL94V-0
- 1.3 Contact:Brass,Tin over Nickel
- 1.4 Solder Tabs:Phosphor Bronze,Tin over Nickel

2.ELECTRIC

- 2.1 Voltage Rating:150V AC/DC
- 2.2 Current Rating:1A AC/DC
- 2.3 Withstanding Voltage:500V AC/minute
- 2.4 Insulation Resistance:500MΩ Min

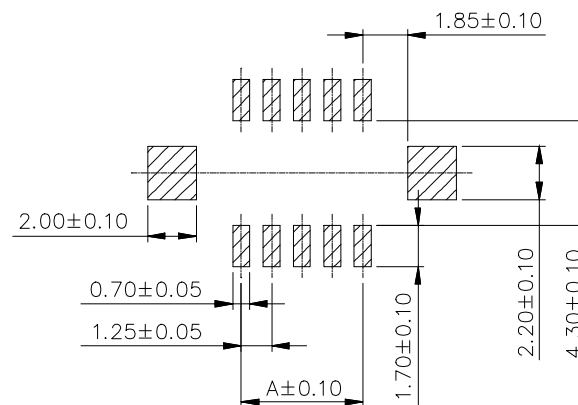
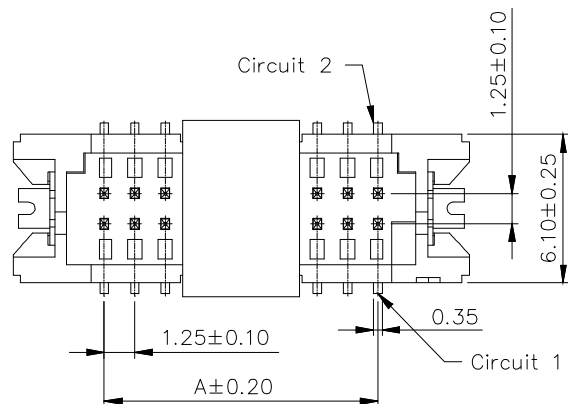
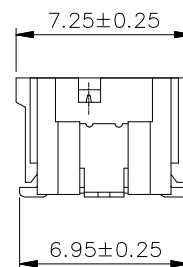
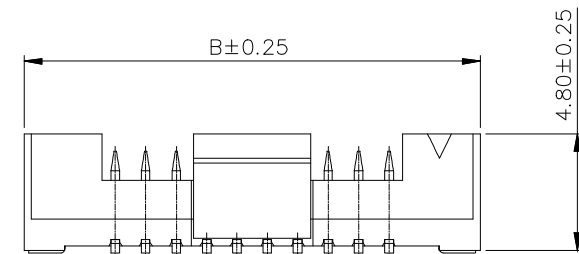
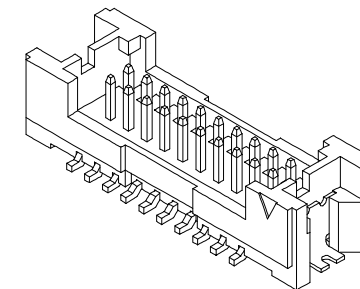
3.Temperature Range:-40°C To +105°C**4.Packing:Reel****P.C.B LAYOUT**

Poles	Part No.	Dimensions (mm)	
		A	B
10	A-WBP-D004DG-10SR01	5.00	12.50
14	A-WBP-D004DG-14SR01	7.50	15.00
20	A-WBP-D004DG-20SR01	11.25	18.75
30	A-WBP-D004DG-30SR01	17.50	25.00
40	A-WBP-D004DG-40SR01	23.75	31.25

RoHS compliant

unit:mm

Scale Free

TOLERANCE

X. ±0.35

X.X ±0.25

X.XX ±0.20

X.XXX ±0.15

DIM TOL

Angle TOL

Id.

②

①

①

①

①

①

①

Update the housing color
10.27.2022 Peter

Update the housing color and terminal material strip
06.17.2022 Peter

Drawn
01.08.2022 Peter

modification
Date Name

Date

Name

Drawn

01.08.2022

Peter

Approved

10.27.2022

Peter

Description: Wire to Board Wafer
Pitch 1.25mm 180° SMT

ASSMANN WSW-NO.

A-WBP-D004DG-xxSR01

Drawing-No.

ASS 9200 CO

rev02

Customer-No.

SHEET
7 / 8

1

2

3

4

5

6

7

SV4422

1

2

3

4

5

6

7

A

B

C

D

E

F

G

H

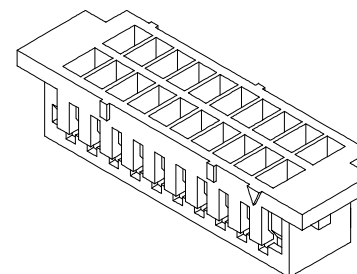
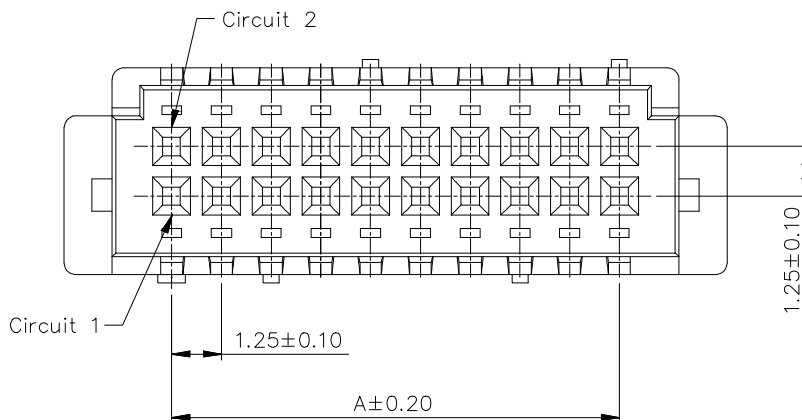
**NOTE:**

- 1.MATERIAL
 ②① 1.1 Insulator:Nylon 66,UL94V-0,Gray
- 2.ELECTRIC
 2.1 Voltage Rating:150V AC/DC
 2.2 Current Rating:1A AC/DC
 2.3 Withstanding Voltage:500V AC/minute
 2.4 Insulation Resistance:500MΩ Min
- 3.Temperature Range:-40°C To +105°C
 4.Packing:PE bag

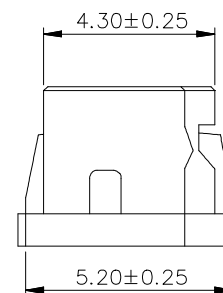

Poles	Part No.	Dimensions (mm)	
		A	B
10	A-WBH-D004DG-10CB01	5.00	10.40
14	A-WBH-D004DG-14CB01	7.50	12.90
20	A-WBH-D004DG-20CB01	11.25	16.65
30	A-WBH-D004DG-30CB01	17.50	22.90
40	A-WBH-D004DG-40CB01	23.75	29.15

RoHS compliant

unit:mm

Scale Free

TOLERANCE

X. ±0.35

X.X ±0.25

X.XX ±0.20

X.XXX ±0.15

DIM TOL

Angle TOL

Id.

modification

Date

Name

Date

Name

Description: Wire to Board Housing
Pitch 1.25mm

ASSMANN WSW-NO.

A-WBH-D004DG-xxCB01

Drawing-No.

ASS 9200 CO

rev02

Customer-No.

SHEET
8 / 8

1

2

3

4

5

6

7

SV4422