

PCB LAYOUT

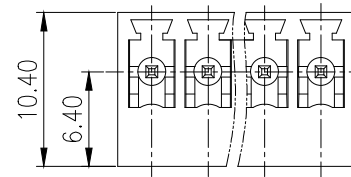
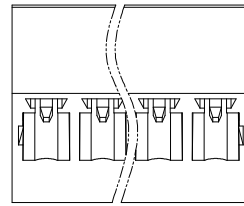

VIEW V

Note:

- 1. Material
 - 1.1 Item (1) Housing: PA66, UL 94V-0, Green
 - 1.2 Item (2) Contact: Copper Alloy, Tin plated
- 2. Electrical
 - 2.1 Voltage Rating: 300V/250V
 - 2.2 Current Rating: 8A/12A
 - 2.3 Withstanding Voltage: 2500V AC/1Min
- 3. Operating Temperature: -40°C to +105°C
- 4. Wave Soldering Temperature: +250°, 5S

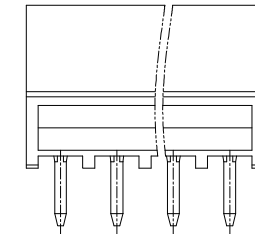
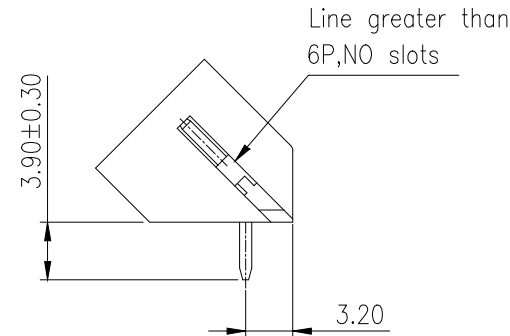
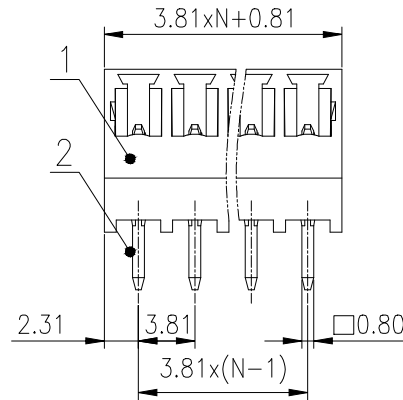
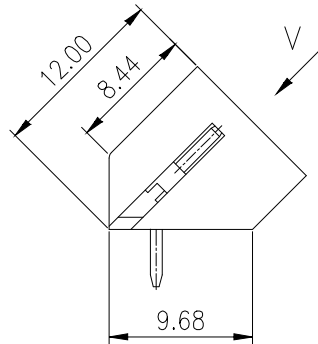

DIM	0~3	>3~6	>6~10	>10~18	>18~30	>30~50	>50~80	>80~120	>120~180	>180~250	>250~315	>315~400	>400~500	>500
TOL	±0.12	±0.18	±0.22	±0.26	±0.31	±0.37	±0.57	±0.80	±0.93	±1.05	±1.15	±1.60	±2.20	±2.50

RoHS compliant
Unit: mm

Scale	Free	Date		Name		Description: Terminal Block	
TOLERANCE		Drawn	11.03.2023	Winnie	Pitch 3.81mm THT		
		Approved	11.03.2023	Winnie	ASSMANN WSW-No. A-TB0381-xxMPM01-GN		
DIM	TOL	Drawing-No.		ASSMANN		ASS 9707 CO	
				WSW components		rev00	
Angle	TOL	① Drawn	11.03.2023	Winnie	A company of BCS		Customer-No.
		Id.	Modification	Date	Name	Sheet 1 / 1	

1

2

3

4

5

6

7