

Auf dem Schüffel 1  
D-58513 Lüdenscheid  
Tel.: +49-2351 - 554-0  
Fax +49 (2351) 554-861  
info@assmann-wsw.com  
www.assmann-wsw.com

## Product Change Notification(PCN)

Issue Date: 03.06.2019  
Modification / Revision Date: 03.06.2019

### V5616x-T 35x17x13mm Stamping heatsinks black anodized

**Change Notification:** PCN 20190404 V5616x-T

**Description of changes:** Change of production plant  
1. Change of tolerance  
2. Draw.-No. ASS\_0488\_HSrev03 substitutes ASS\_0488\_HSrev02

**Date of change and Implementation:** Change: Week 23 / year 2019  
Implementation: 03.06.2019

**Key Characteristics of Change:** tolerance see page 3

**Products Affected:** V5616x-T

**Reason for Change:** Change of production plant

**Response :** No response to this notification is required.

#### PCN Revision History:

Date of Revision: 03.06.2019

Revision Number: 00

page 1/4

Auf dem Schüffel 1  
D-58513 Lüdenscheid  
Tel.: +49-2351 - 554-0  
Fax +49 (2351) 554-861  
info@assmann-wsw.com  
www.assmann-wsw.com

## Product Change Notification(PCN)

Issue Date: **03.06.2019**  
Modification / Revision Date: **03.06.2019**

**Reference Documents / Attachments:**

Document: Drawing

ASSMANN WSW P/N	Drawing Number
V5616X-T	ASS_0488_HSrev03
V5616Y-T	

**PCN Revision History:**

Date of Revision: 03.06.2019

Revision Number: 00

Auf dem Schüffel 1  
 D-58513 Lüdenscheid  
 Tel.: +49-2351 - 554-0  
 Fax +49 (2351) 554-861  
 info@assmann-wsw.com  
 www.assmann-wsw.com

## Product Change Notification(PCN)

Issue Date: 03.06.2019  
 Modification / Revision Date: 03.06.2019

V5616x-T	Old version	V5616x-T	New version																																				
1. Change of tolerance:		1. Change of tolerance:																																					
<table border="1"> <tr><td>Scale</td><td>1:1</td></tr> <tr><td colspan="2">TOLERANCE</td></tr> <tr><td>X.</td><td>±X</td></tr> <tr><td>X.X</td><td>±X</td></tr> <tr><td>X.XX</td><td>±X</td></tr> <tr><td>DIM</td><td>TOL</td></tr> <tr><td>X.°</td><td>±X°</td></tr> <tr><td>X.X°</td><td>±X°</td></tr> <tr><td>Angle</td><td>TOL</td></tr> </table>		Scale	1:1	TOLERANCE		X.	±X	X.X	±X	X.XX	±X	DIM	TOL	X.°	±X°	X.X°	±X°	Angle	TOL	<table border="1"> <tr><td>Scale</td><td>Free</td></tr> <tr><td>③ TOLERANCE</td><td></td></tr> <tr><td>0-6</td><td>±0.10</td></tr> <tr><td>6-30</td><td>±0.20</td></tr> <tr><td>30-120</td><td>±0.30</td></tr> <tr><td>120-400</td><td>±0.50</td></tr> <tr><td>DIM</td><td>TOL</td></tr> <tr><td></td><td></td></tr> <tr><td>Angle</td><td>±0.5°</td></tr> </table>		Scale	Free	③ TOLERANCE		0-6	±0.10	6-30	±0.20	30-120	±0.30	120-400	±0.50	DIM	TOL			Angle	±0.5°
Scale	1:1																																						
TOLERANCE																																							
X.	±X																																						
X.X	±X																																						
X.XX	±X																																						
DIM	TOL																																						
X.°	±X°																																						
X.X°	±X°																																						
Angle	TOL																																						
Scale	Free																																						
③ TOLERANCE																																							
0-6	±0.10																																						
6-30	±0.20																																						
30-120	±0.30																																						
120-400	±0.50																																						
DIM	TOL																																						
Angle	±0.5°																																						
For detail, please take attached new drawing for reference: ASS_0488_HSrev03																																							

### PCN Revision History:

Date of Revision: 03.06.2019

Revision Number: 00

page 3/4

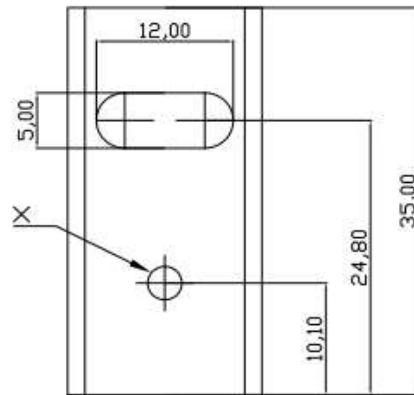
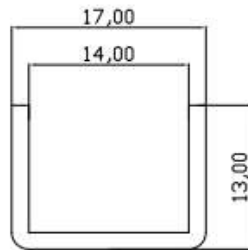

Notes  
Material: AL99.5

Option	Dimension x	Version	Thermal resistance
V5616X-T	M 3,0	Black anodized	17
V5616Y-T	Ø 3,2	Black anodized	17

RoHS compliant  
Unit: mm

Scale	Free					Date	Name	Customer-No.
TOLERANCE						Drawn	12.10.2009	Schulz
0-6	±0.10					Approved	04.04.2019	Amy
6-30	±0.20							ASSMANN WSW-No. ② V5616x-T
30-120	±0.30	③	Add the tolerance	04.04.2019	Segal			Drawing-No.
120-400	±0.50	②	Modify P/N	11.10.2010	Dean			ASS 0488 HS rev03
DIM	TOL	①	Drawn	12.10.2009	Schulz			Replace
Angle	±0.5°	Id.	Modification	Date	Name			

